



Spectre ARGB SE Kit



The well known BitFenix Spectre fan series adds a new member to the family with introduction of the all new BitFenix Spectre ARGB SE fans.

Adopting a simple and elegant design to match with modern aesthetics, the Spectre ARGB SE builds up on the performance of the last model by offering better airflow at a lower noise level.

Eight individually addressable RGB LEDs featuring TriBright™ LED Technology lights up the fan with vibrant and bright colors that can be controlled with the included controller in 60 different modes or via motherboard software.



TriBright™ LED Technology

The Spectre ARGB SE features the TriBright™ LED Technology which was well received in our Alchemy 3.0 Addressable RGB LED Strips, thus offering higher color saturation, increased brightness and a longer life. Furthermore, the light is more evenly scattered, casting softer shadows, increasing the overall illumination effect.



GIGABYTE™



The Spectre ARGB SE and the controller was developed in close cooperation with ASUS, ASRock, Gigabyte and MSI, thus making it flawlessly sync with their motherboard RGB control software. Being based on the same technology (+5V 3pin connector) as other BitFenix addressable RGB products, such as the cases ENSO and the Alchemy 3.0 Addressable RGB LED Strip, it perfectly matches in colors while also making it cross compatible between other BitFenix' RGB controllers and accessories.



The new and improved controller included in the kit offers extensive customization options for RGB as well as multiple extensions of outputs to control up to 36W for all fan power sockets and 36 LEDs for each ARGB socket.

With up to 60 different RGB modes and custom fan speeds, there are plenty of new and interesting lighting effects to fit your system. For even more customization, the controller itself can be connected to the motherboard to switch to motherboard control on the fly with the included remote.

Connect Only The Controller in Fan Kit



Connect With Motherboard



Connect With BitFenix Controller

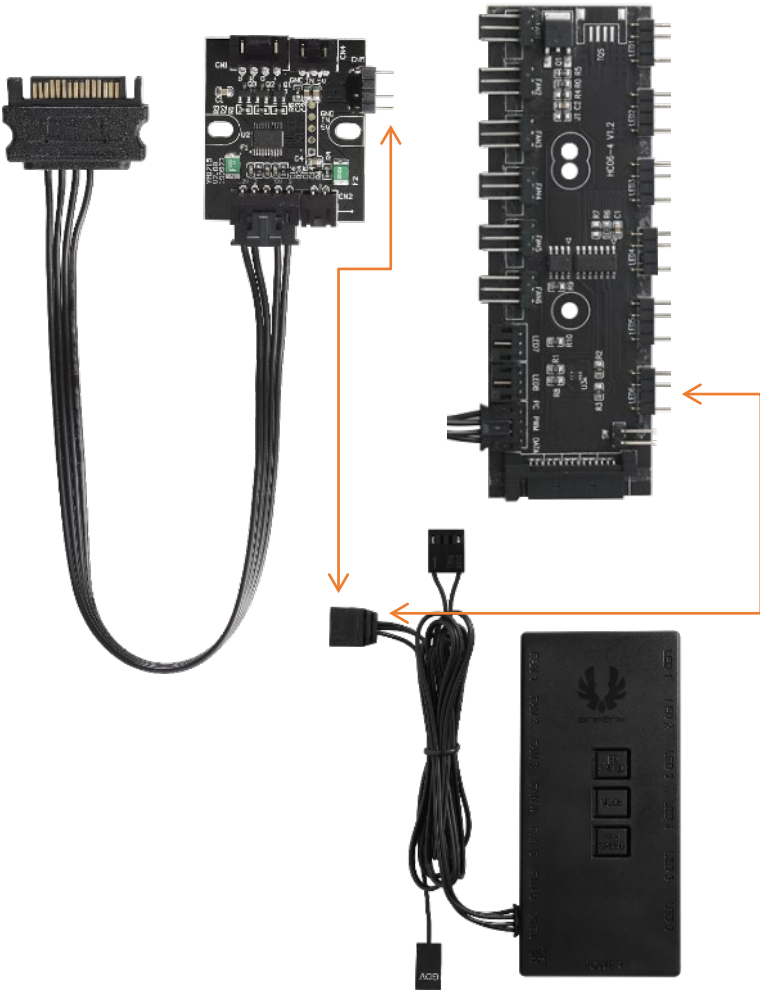

Controller

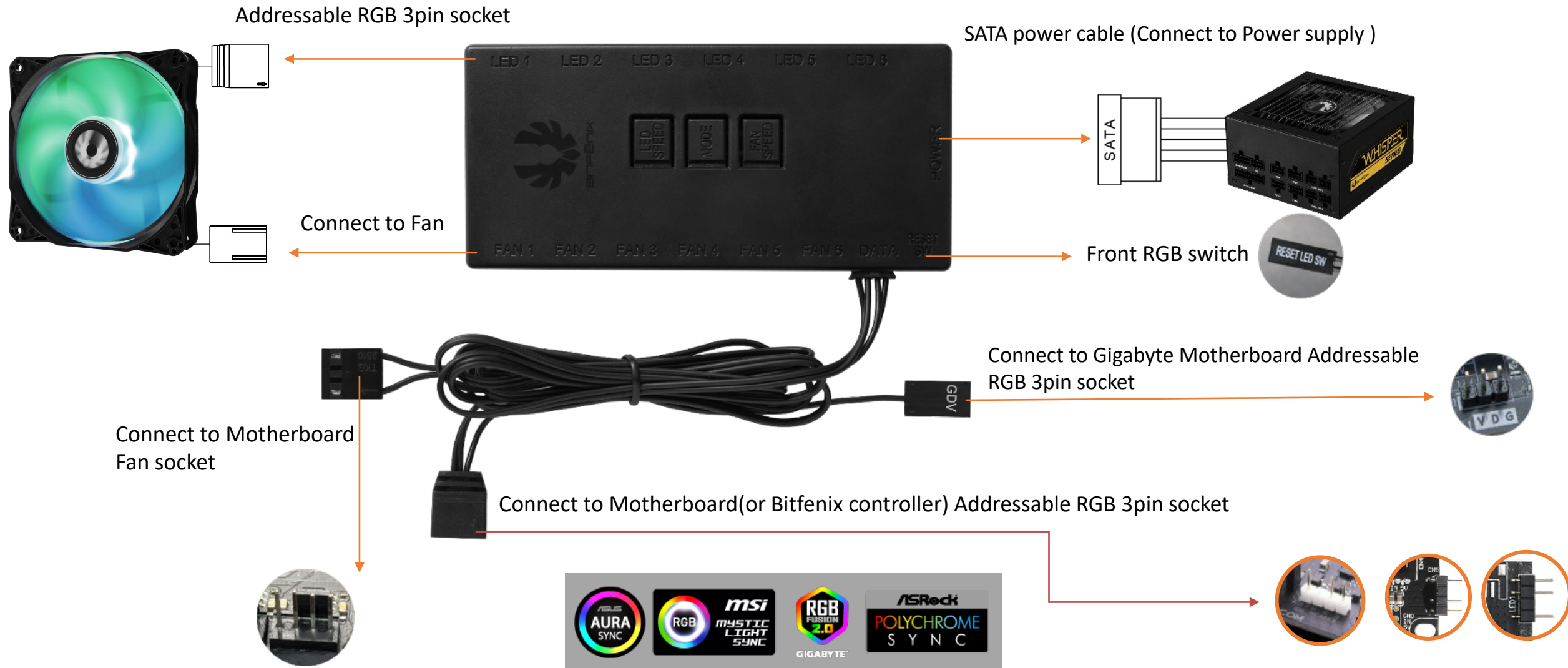

Please DO NOT connect V D G header and ARGB header together on Motherboard at the same time.



Remote



M/B sync: Switch to M/B control or controller control

Q1, Q2, Q3, Q4, Q5: Five different preset modes

Fan AUTO: Switch to Motherboard control or controller control

FAN +/-: Switch to High speed (100%RPM) and low speed (70%RPM) on controller

LED SPEED: Light speed adjustment for non-solid color mode(5 different speed)

HOLD: Lighting action play or pause

R: Red lighting mode

G: Green lighting mode

B: Blue lighting mode



Select mode up



Select mode down



Lock or unlock the button on remote



Sickled Fan Blade Design

High rotation speeds can actually warp fan blades while in motion, resulting in more turbulence and noise. Spectre ARGB SE features 9 Sickled fan blades that resist warping even when spinning at high speeds for maximum cooling performance. The LEDs of the Spectre ARGB SE are located at the core of the fan, providing bright illumination throughout the fan blades and the frame.

	Spectre ARGB SE kit - WHITE	Spectre ARGB SE kit - BLACK
Part no.	BFF-ADD-12025SW-3CP	BFF-ADD-12025SK-3CP
EAN	4712883217616	4712883217623
UPC	886027157916	886027157923
Fan Dimensions	120x120x25mm	
RGB chip Quantity	8 PCS	
Bearing Type	Hydraulic Bearing	
Rating Voltage	DC 12V (FAN) DC 5V (LED)	
Operating Voltage	DC 6-13.2V	
Start Voltage	6V	
Rated Current	DC 12V	
Power Consumption	Fan: 2.4W LED: 1.5W	
Fan Speed	1200 ± 200 RPM	
Air Flow	33.2 CFM	
Air Pressure	<0.98 MM-H2O	
Noise	24.4 dB-A	