



Shinobi

Quick Installation Guide



Box Contents

Shinobi

- **Shinobi Case**
- **Shinobi Quick Installation Guide**

- **Accessory Pack:**

- ⊕ 5.25" to external 3.5" drive bay cover: x 1
- ⊕ 5.25" drive bay adapter: x 1
(pre-installed in chassis)
- ⊕ Cable Ties: x 10
- ⊕ Lock Loop: x 1
- ⊕ Case Feet: x 4

- **Screws:**

- ⊕ M3 Thumbscrews: x 8 (for 5.25" ODD)
- ⊕ M3 Round: x 13 (for Motherboard, FDD and 2.5" HDD/SSD)
- ⊕ 6-32 Thumbscrews: x 20 (for 3.5" HDD)
- ⊕ 6-32 Hex: x 8 (for PSU and 3.5" HDD)
- ⊕ Motherboard Standoffs: x 9
- ⊕ 6-32 Flat: x 1 (for Lock Loop)

Shinobi Window

- **Shinobi Window Case**
- **Shinobi Quick Installation Guide**

- **Accessory Pack:**

- ⊕ 5.25" to external 3.5" drive bay cover: x 1
- ⊕ 5.25" drive bay adapter: x 1
(pre-installed in chassis)
- ⊕ Cable Ties: x 10
- ⊕ Lock Loop: x 1
- ⊕ Case Feet: x 4

- **Screws:**

- ⊕ M3 Round: x 13 (for Motherboard, FDD and 2.5" HDD/SSD)
- ⊕ 6-32 Hex: x 8 (for PSU and 3.5" HDD)
- ⊕ Motherboard Standoffs: x 9
- ⊕ 6-32 Flat: x 1 (for Lock Loop)

* Contents and specifications subject to change without notice.

Basic Installation

Removing side panels

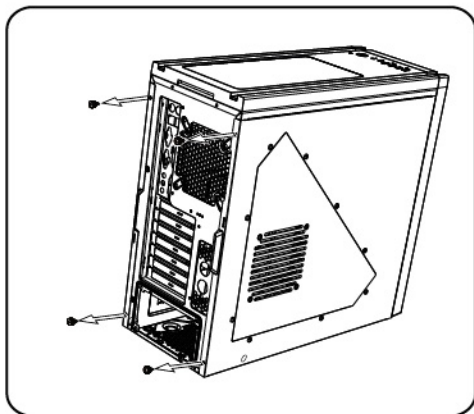

a. Remove thumbscrews

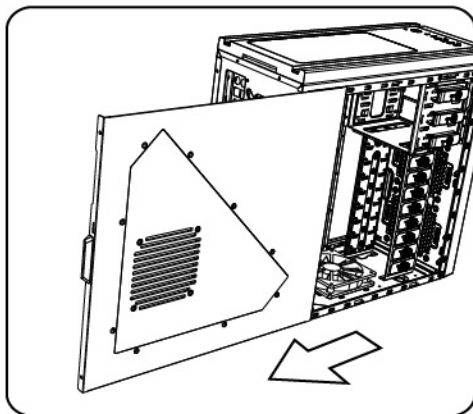

b. Slide off side panels

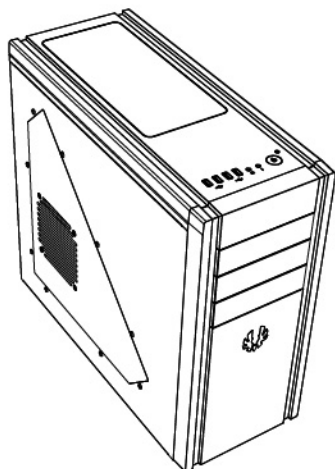

Shinobi Window

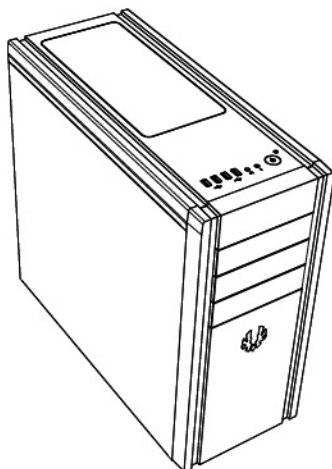

Shinobi

Installing 5.25" drives

Shinobi

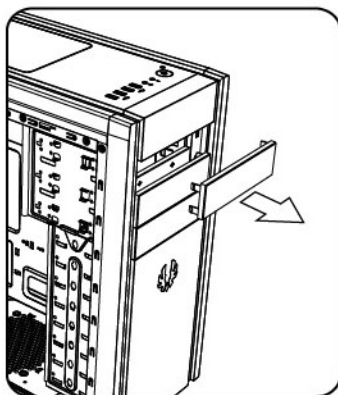

a. Remove drive cover

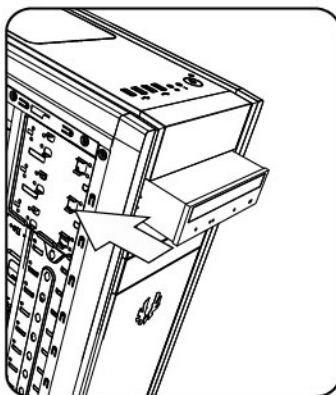

b. Slide drive into drive bay

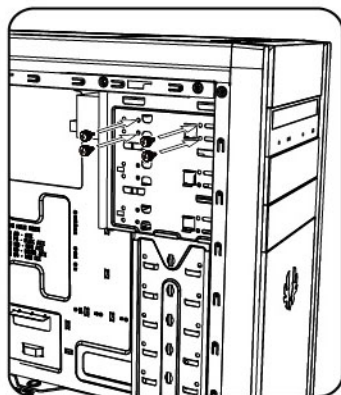

c. Add thumbscrews
(M3 Thumbscrews)

Shinobi Window

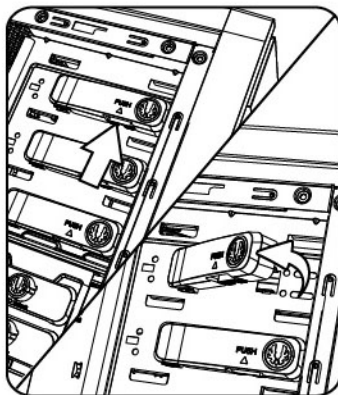

a. Squeeze and pull
drive-locking mechanism

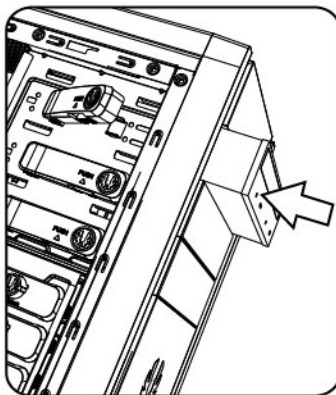

b. Slide drive into drive bay

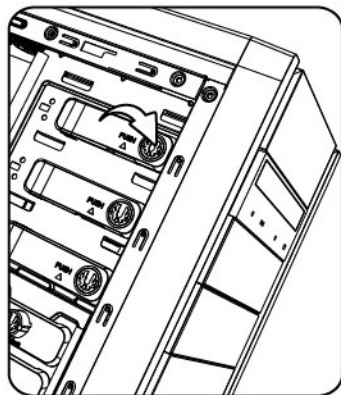

c. Replace drive-locking
mechanism

Installing 3.5" drives

Shinobi

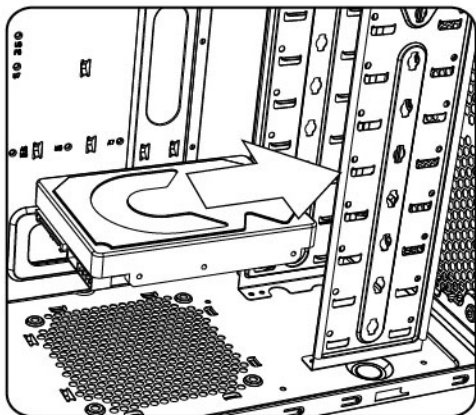

a. Slide drive into drive bay

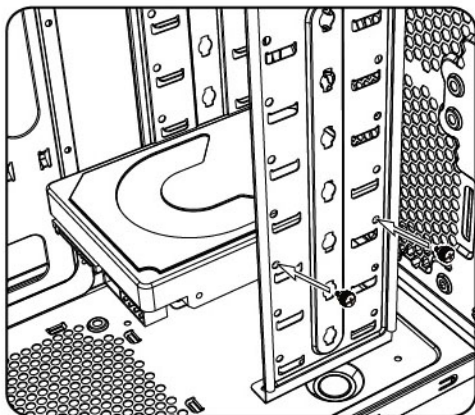

b. Secure with thumbscrews
(6-32 Thumbscrews)

Shinobi Window

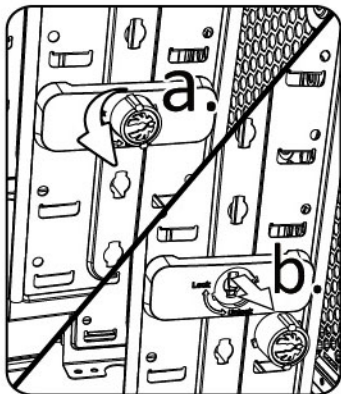

a. Turn and pull drive
-locking mechanism

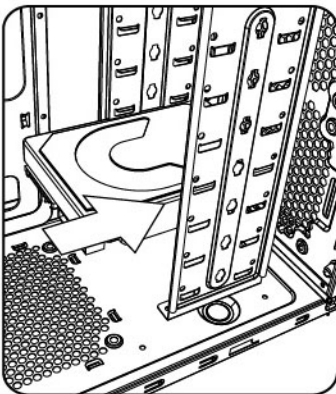

b. Slide drive into drive bay

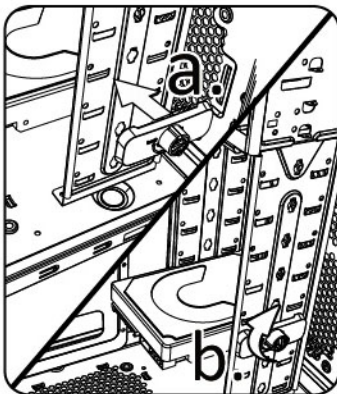

c. Replace drive-locking
mechanism

Using 5.25" drive bay adapter (for 2.5", 3.5", FDD)

Shinobi and Shinobi Window

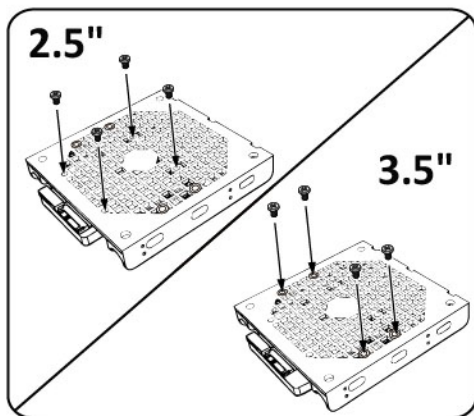

- a. Install device with screws
(M3 Round for 2.5")
(6-32 Hex for 3.5")

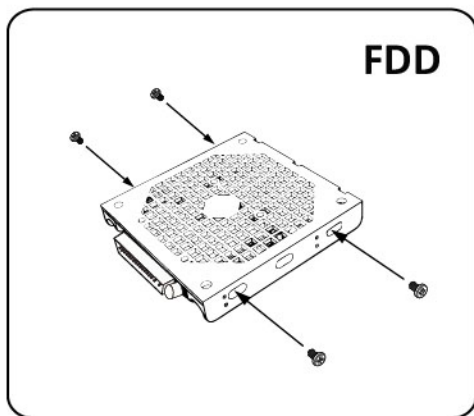

- b. Install device with screws
(M3 Round for FDD)

Shinobi

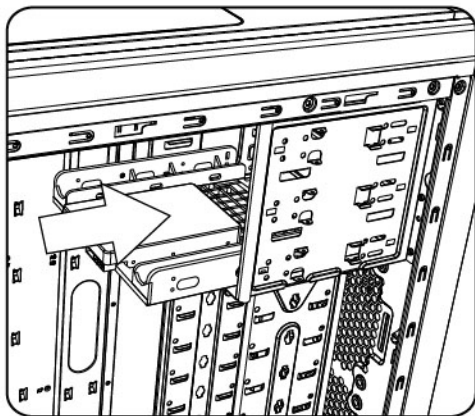

- a. Slide adapter into drive bay

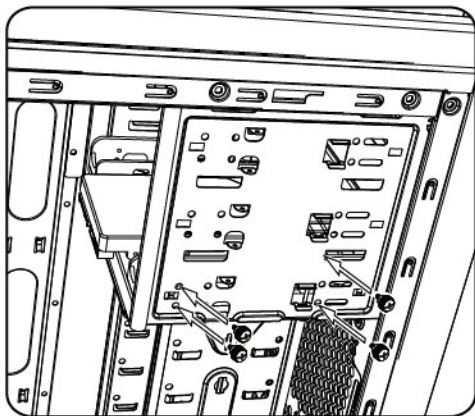

- b. Secure with screws (3-8 screw)

Shinobi Window

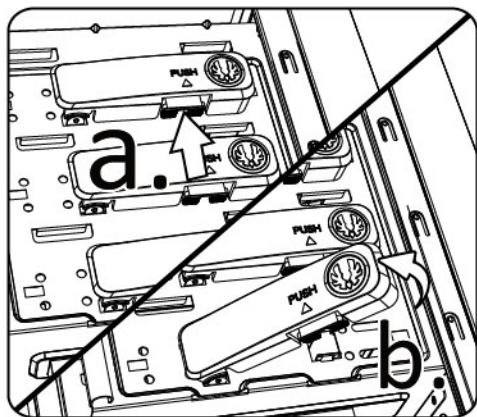

a. Squeeze and pull drive-locking mechanism

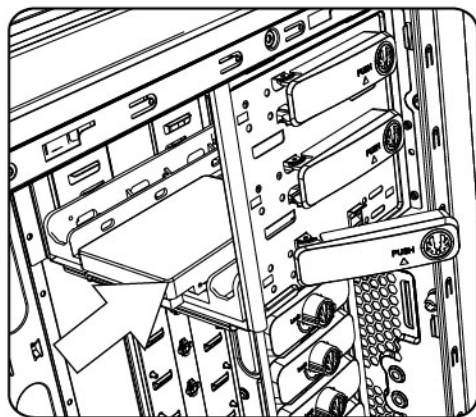

b. Slide adapter into drive bay

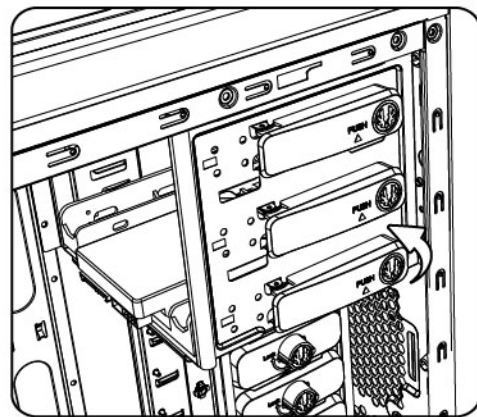

c. Replace drive-locking mechanism

Replacing side panels

Shinobi

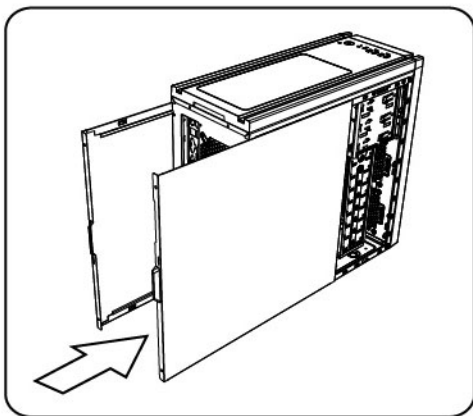

a. Install side panels

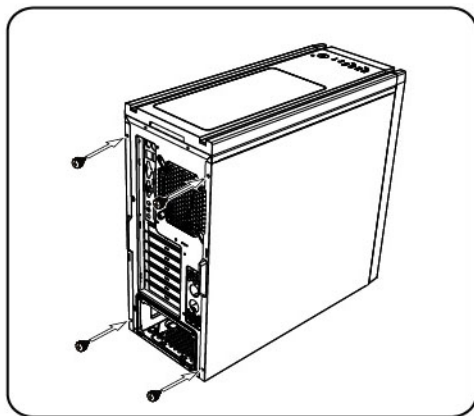

b. Replace thumbscrews

Shinobi Window

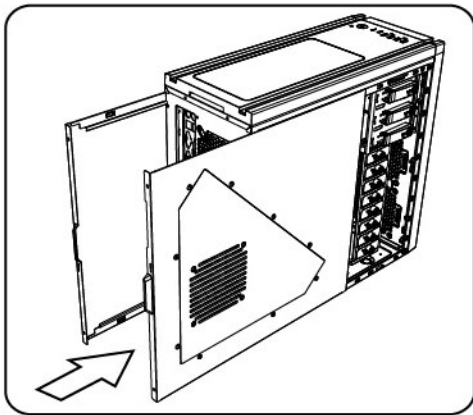

a. Install side panels

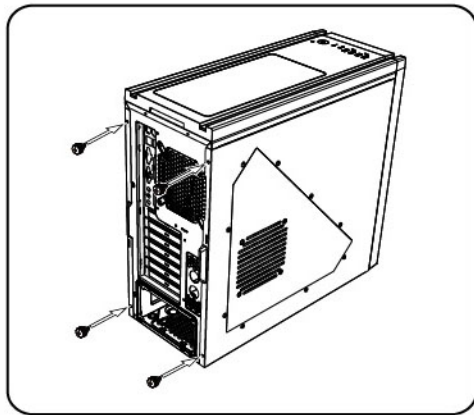

b. Replace thumbscrews

Features

Control Panel

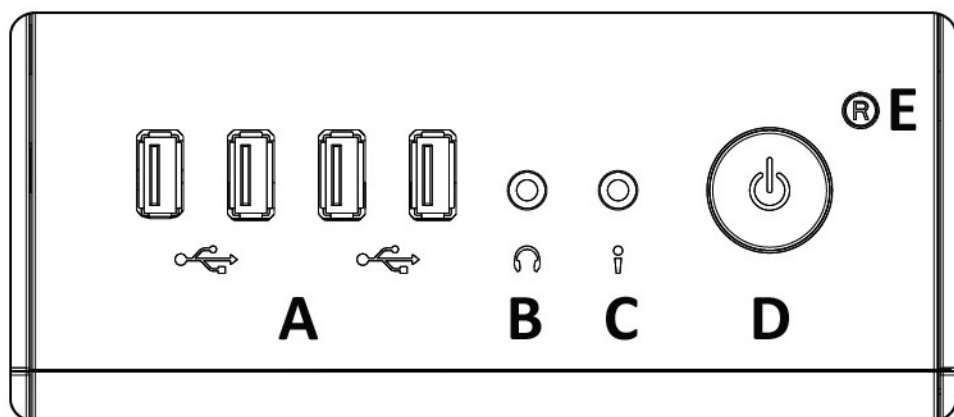

A. USB 2.0

B. Headphone

C. Microphone

D. Power button

E. Reset button

Top Fan Installation

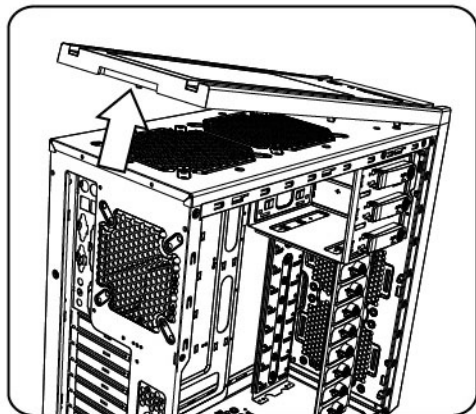

a. Remove top panel

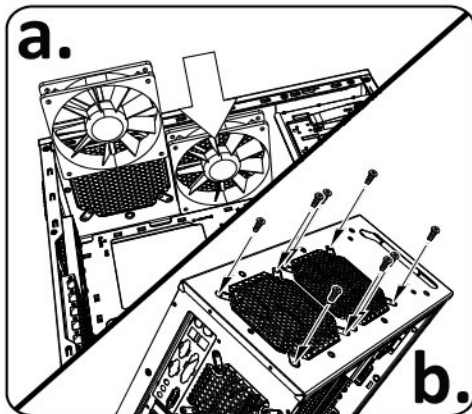

b. Install fan and secure with screws

Rear Fan Installation

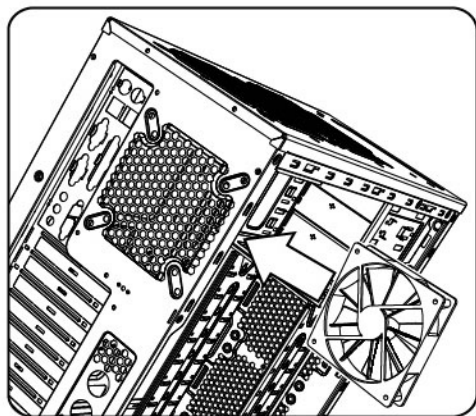

a. Install fan

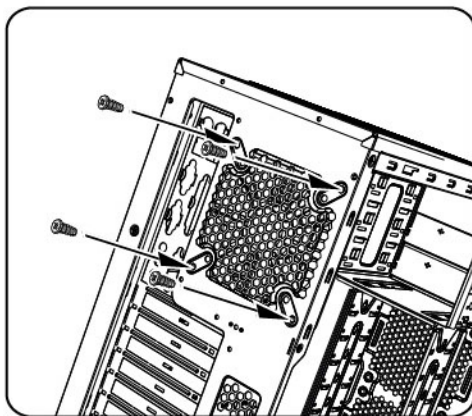

b. Secure with screws

Front Fan Installation

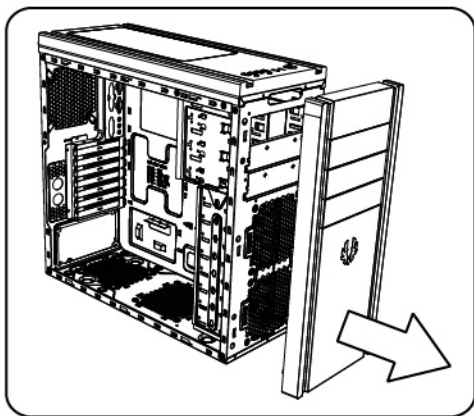

a. Remove front panel

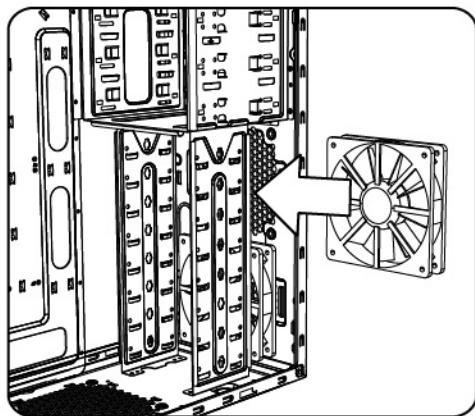

b. Install fan

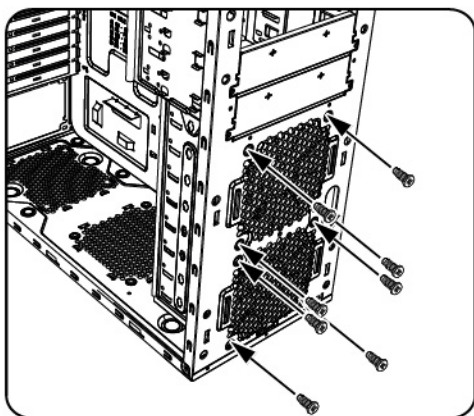

c. Secure with screws

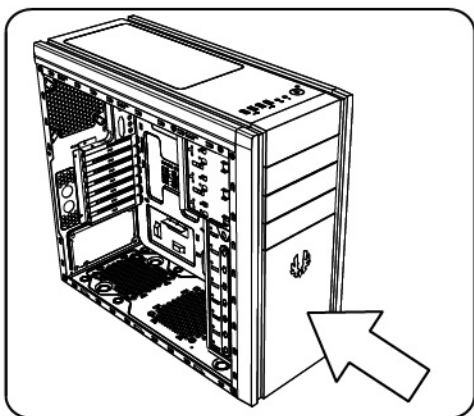

d. Replace front panel

Bottom Fan Installation

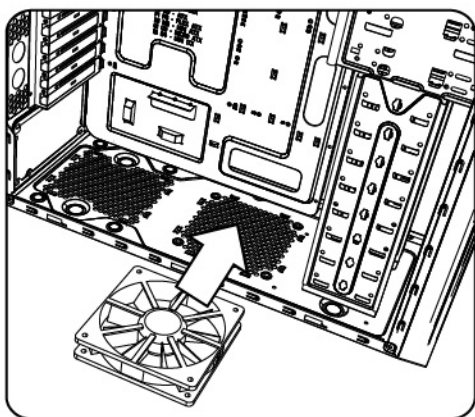

a. Install fan

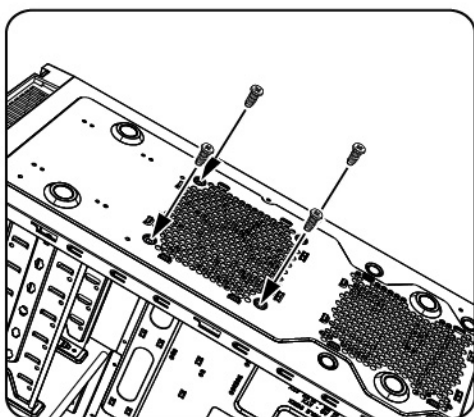

b. Secure with screws

Side Panel Fan Installation (Shinobi Window only)

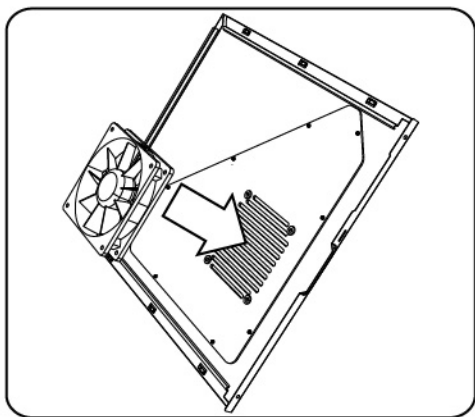

a. Install fan

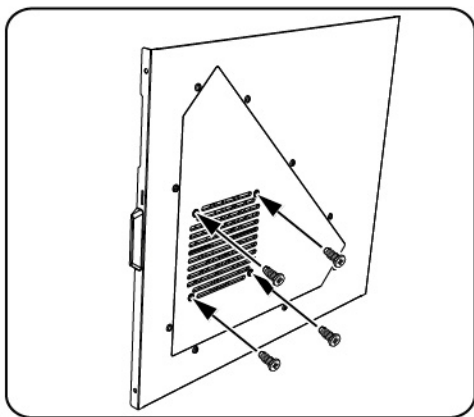

b. Secure with screws

Dust Filters

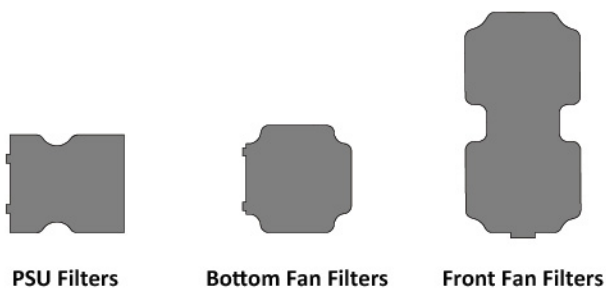
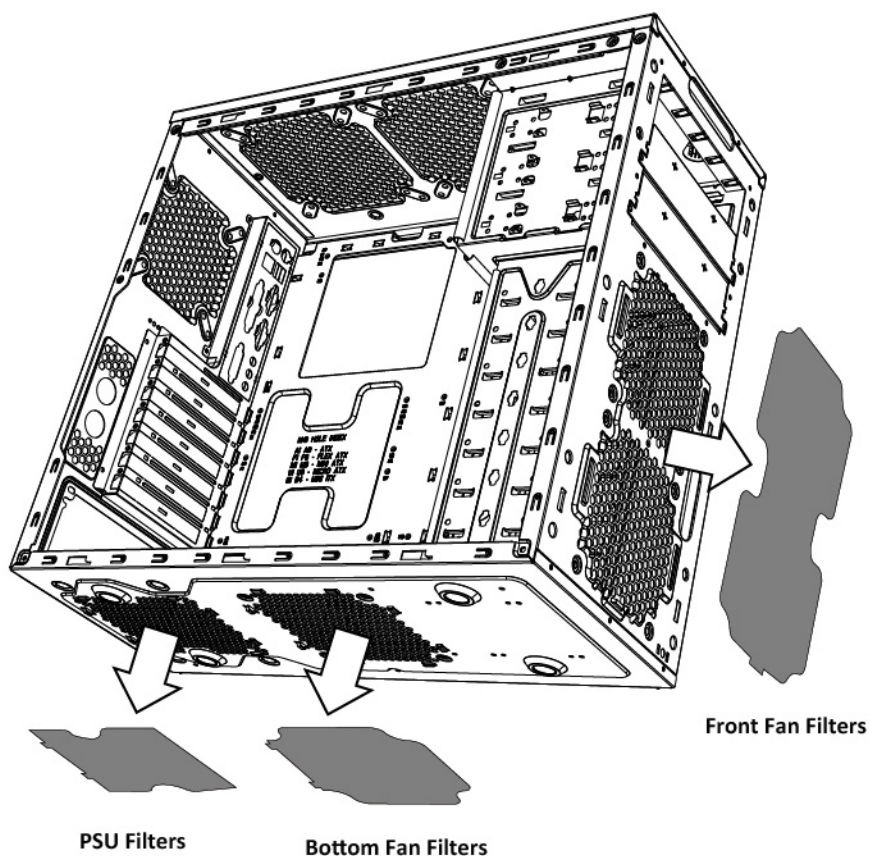



bitfenix

Bitfenix Co., Ltd.

3F, No. 79, Sec. 1, Sintai 5th Rd.,
Sijhih city, Taipei, Taiwan, R.O.C.

For the most updated information, please visit our official website: <http://www.bitfenix.com>

© 2011 BITFENIX Co., Ltd. All Rights Reserved. All trademarks are registered to their respective owners.

Ver 1.0 : 2011/02

