



PRISM

140mm



120mm

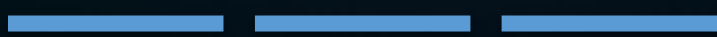

MB

120mm



120mm



360mm AIO
Top-mount support

Dimension

225mm

430mm

430mm

Maximun CPU
Cooler Height
165 mm

Cable Management Space 35mm

Motherboard
Support
ITX
M-ATX
ATX

Maximun Graphics Card
Support **410 mm**

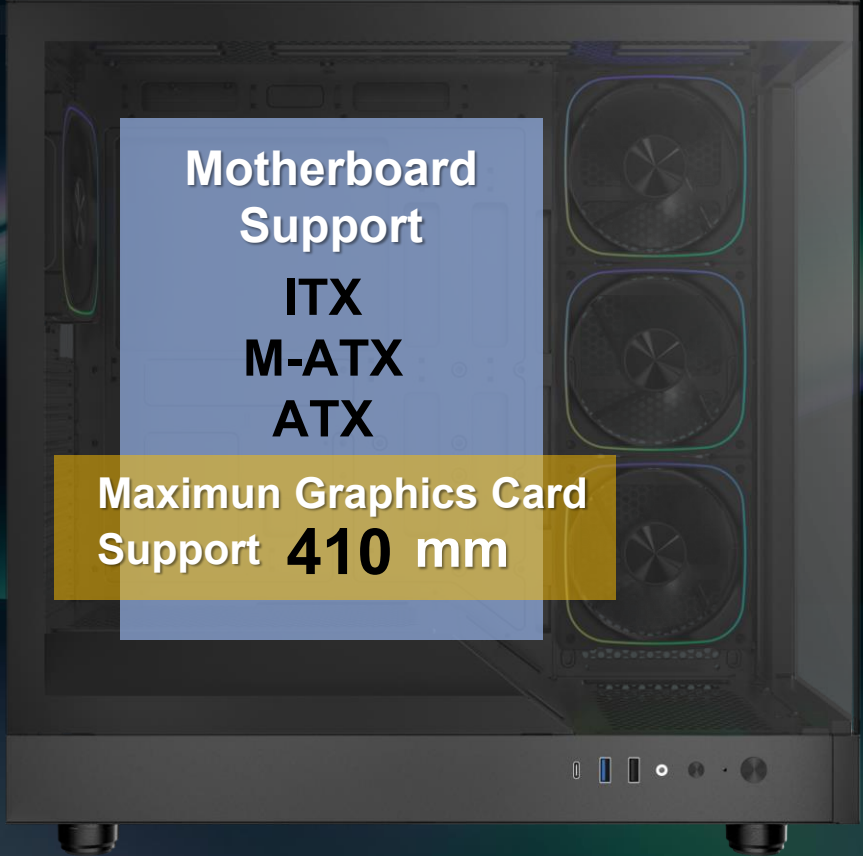



3X

High-Performance
Reverse ARGB Fan



1X

High-Performance ARGB Fan



DUAL CHAMBER
HIGH
AIRFLOW PERFORMANCE

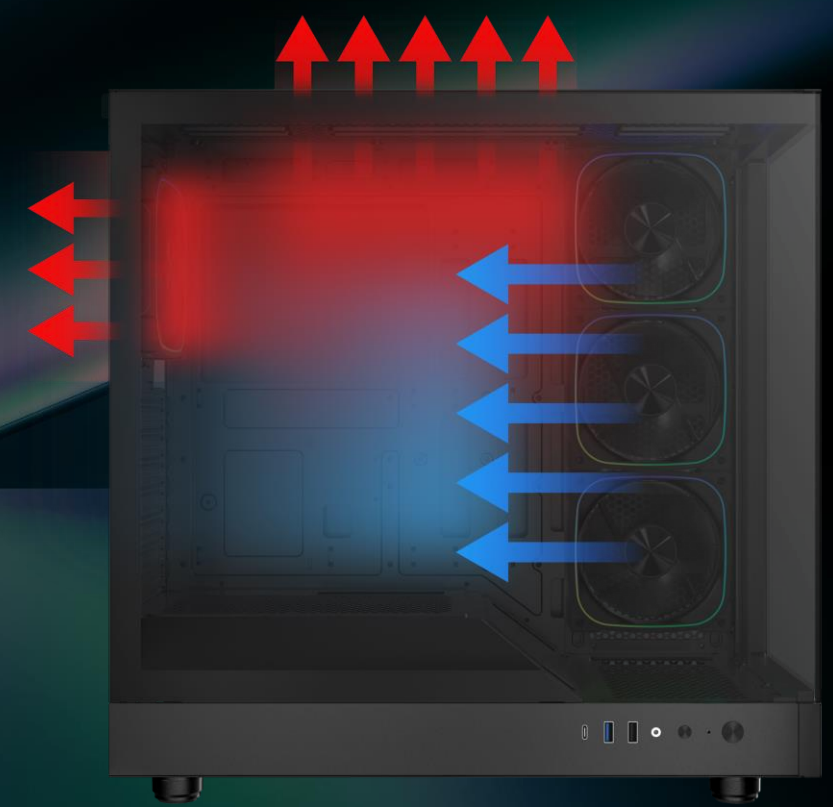

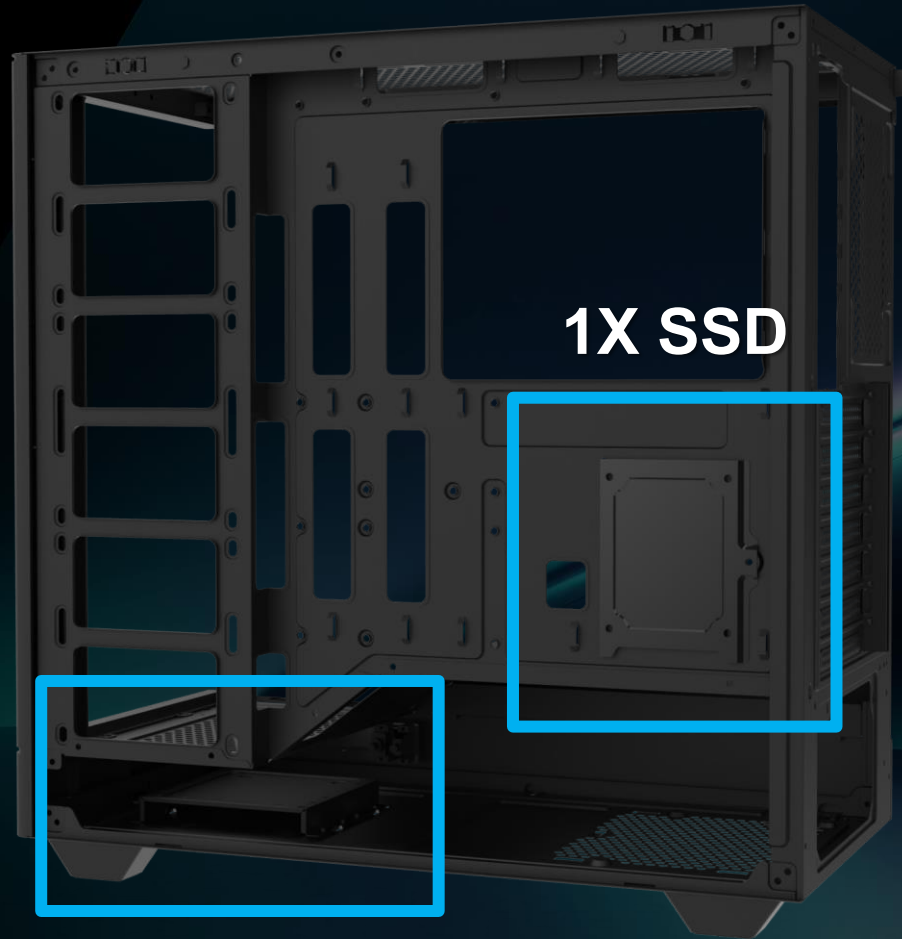

1X SSD

1X SSD & 1X HDD

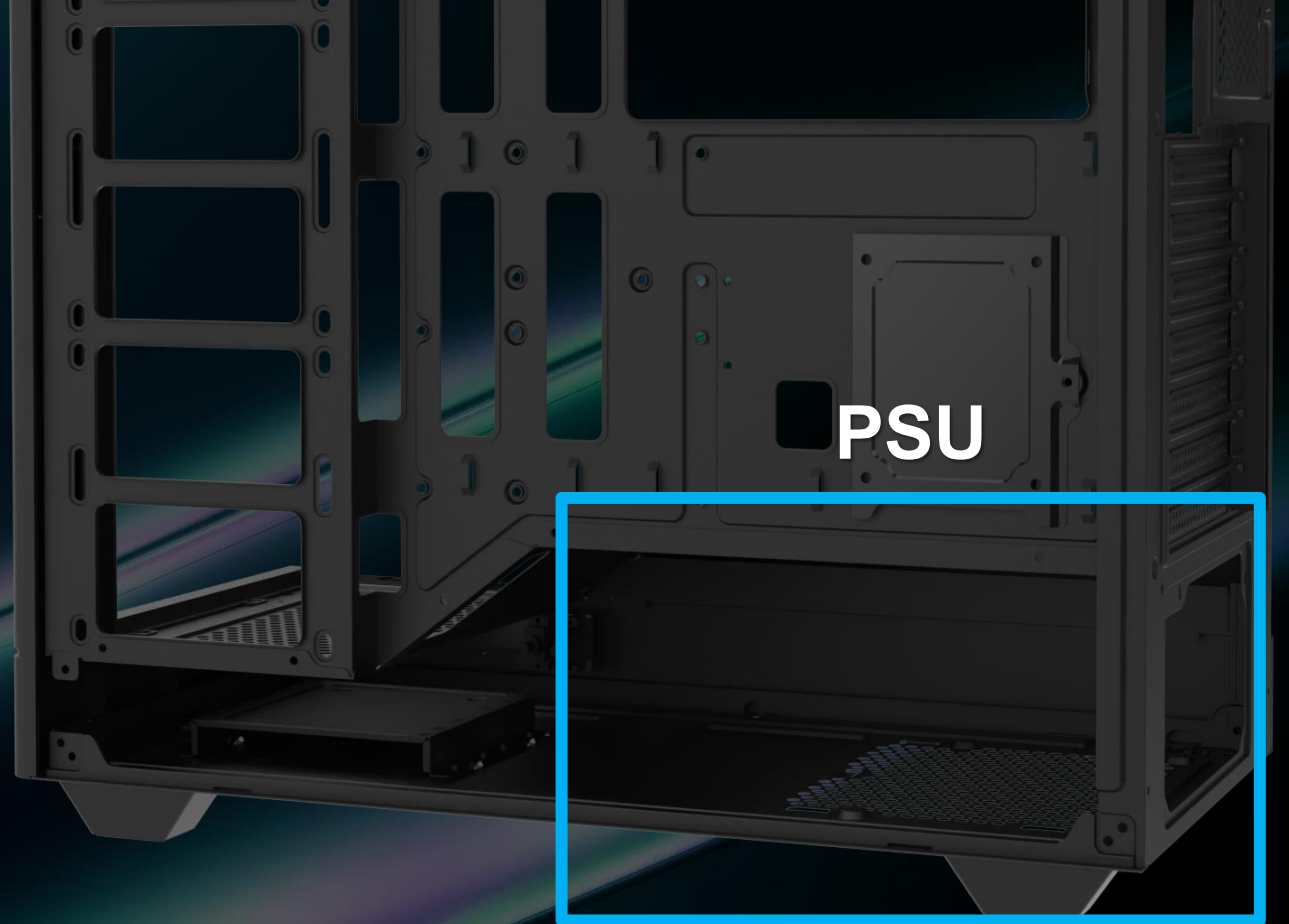

PSU

ATX & Standard /
up to **200**mm

1 X 3.5" Drive & **2** X 2.5" Drive

Top



Bottom

Easy Clean With **Removable** Dust Filters

Tool-free Removal

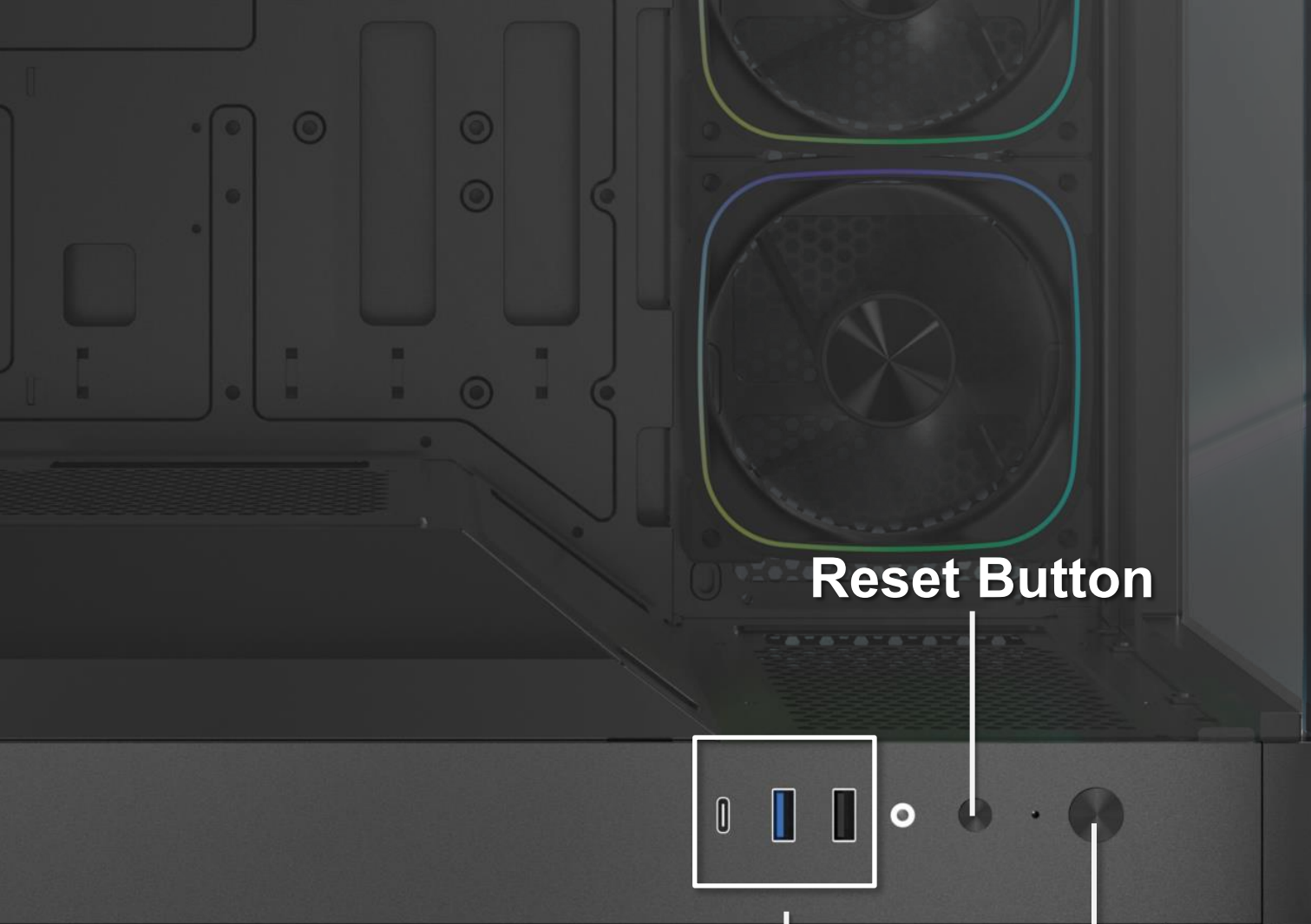

Reset Button

Power Button

1X TypeC

1X USB 3.0 / 1X USB



PRISM

Best	Black	
Part no.	BFC-PRI75KKGKK-4F	
EAN	4716779449846	
UPC	886027007570	
Net weight (NW) Gross weight (GW)	N.W: Kgs / G.W: Kgs	
Materials	Steel, Mesh, Plastic, Tempered Glass	
Chassis Dimensions (W x H x D)	225 mm x 430 mm x 430 mm	
Motherboard Supports	Mini-ITX, MicroATX, ATX	
Air Cooler Height Support	165mm	
VGA Length Support	410mm	
Cable Management Support	up to 35mm	
2.5" / 3.5" Drive Bay	2 / 1	
Fan mounts	MB	3 x 120mm or 2 x 140mm
	Top	3 x 120mm or 2 x 140mm
	Rear	1 x 120mm
Radiator Support	MB	1 x 360mm/ 1 x 280mm/ 1 x 240mm (Thickness up to 27mm)
	Top	1 x 360mm/ 1 x 280mm/ 1 x 240mm (Thickness up to 27mm)
	Rear	1 x 120mm
PCI-E Slots	7 Slots	
I/O Ports	1 x TypeC/ 1 x USB3.0/ 1 x USB1.0/ Audio I/O	
Power Supply	ATX & Standard / up to 200mm	

PRISM