



PANDORA ATX

Quick Installation Guide

Contents

- **PANDORA ATX CASE**

- **PANDORA ATX Quick Installation Guide**

- Accessory:

- ➞ Aluminum BitFenix Logo
- ➞ 20 x HDD Anti-vibration Washers
- ➞ 1 x Reservoir Bracket (PANDORA ATX Only)
- ➞ 1 x Water Pump Bracket (PANDORA ATX Only)
- ➞ 6 x Cable Ties

- Screws:

- ➞ 25 x Standard Screw M3*5mm Round (For 2.5"SSD & MB tray)
- ➞ 3 x Motherboard Black Standoffs
- ➞ 4 x Thumbscrews M3
- ➞ 16 x Standard Screw 6*6mm Round (For 3.5"HDD)
- ➞ 6 x Standard Screw 6-32 (For PSU)

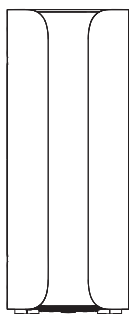

Front

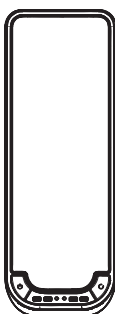

Top

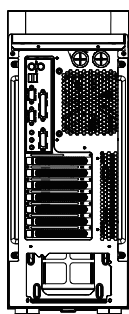

Back

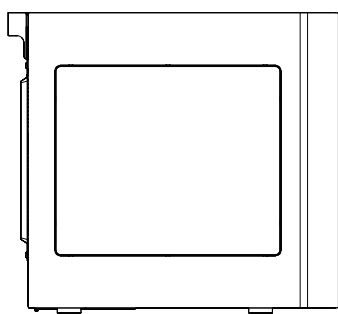

Side

Basic Installation

Removing side panels

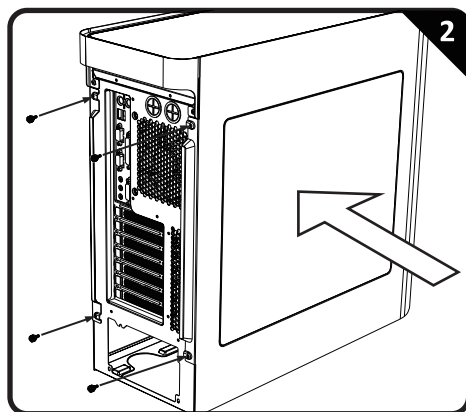
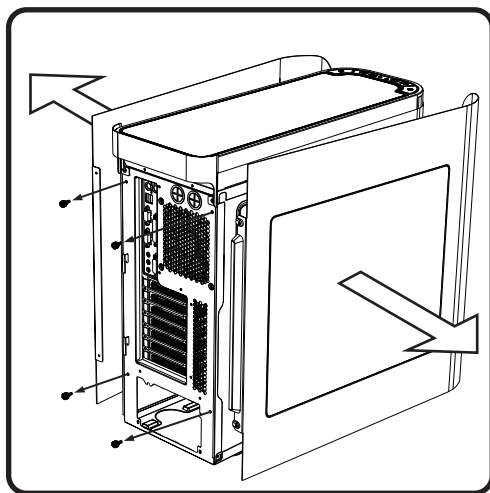
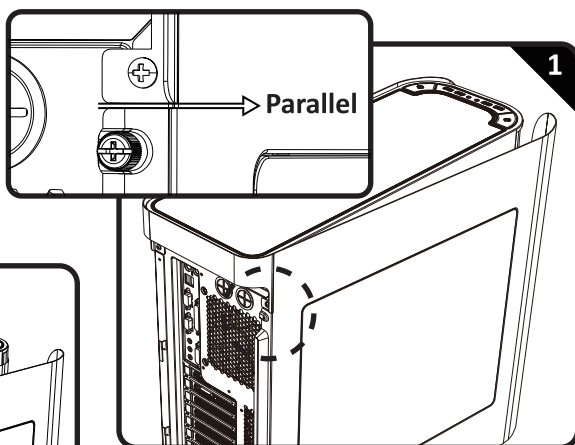

Remove Filters

TOP

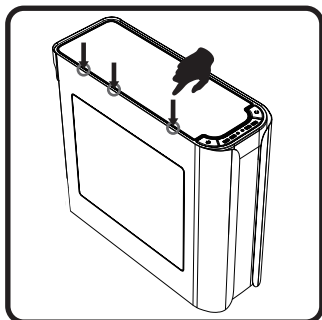

a. Push latch

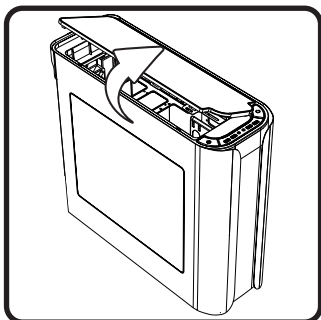

b. Open filter

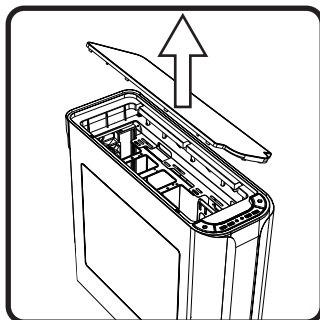

c. Remove top filter

FRONT

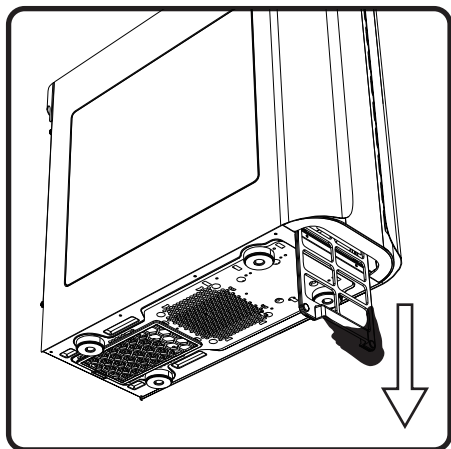

a. Remove front filter

BOTTOM

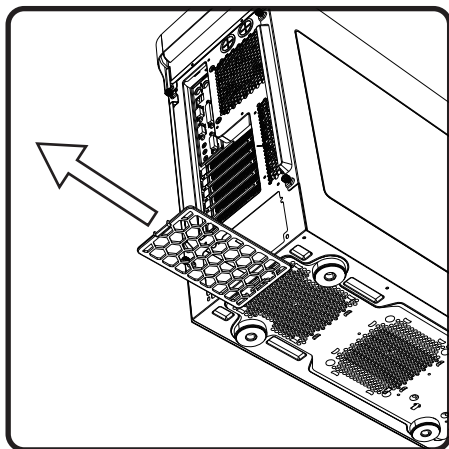

a. Remove bottom filter

Installing 3.5" Drives

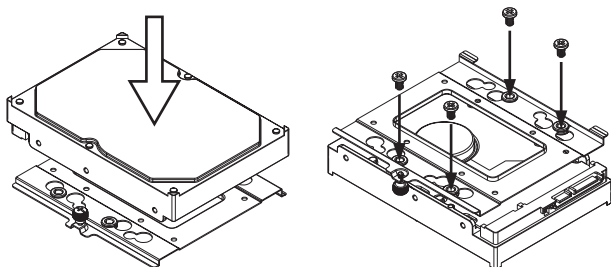

3.5" Drives Location

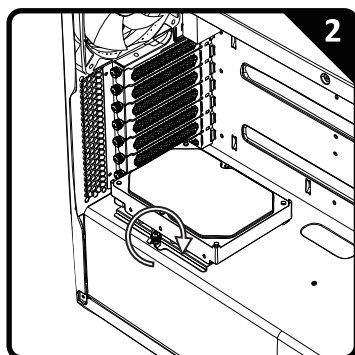
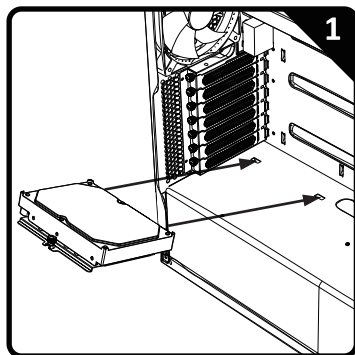
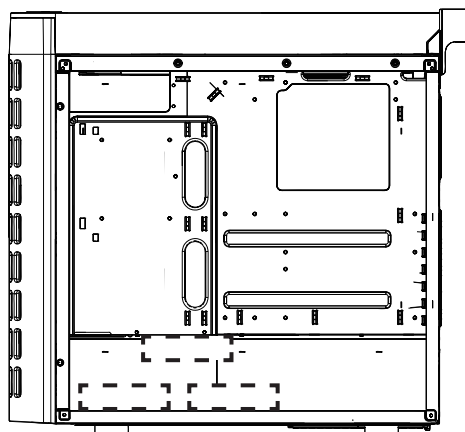
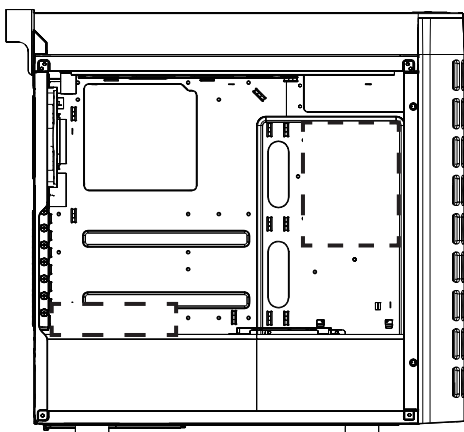
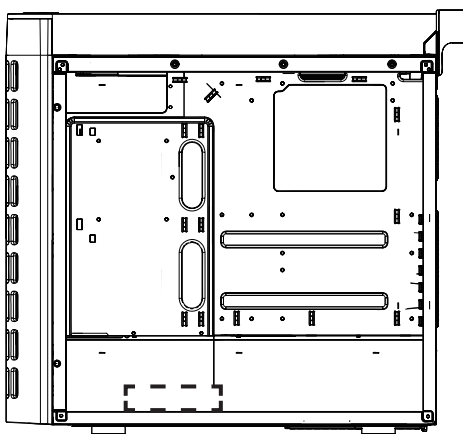

Installing 2.5" Drives

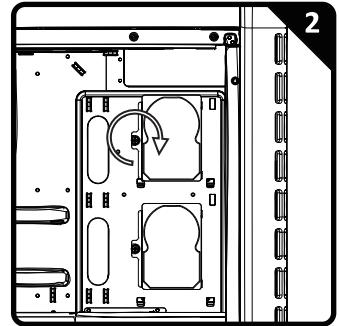
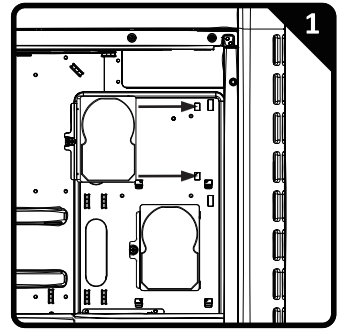
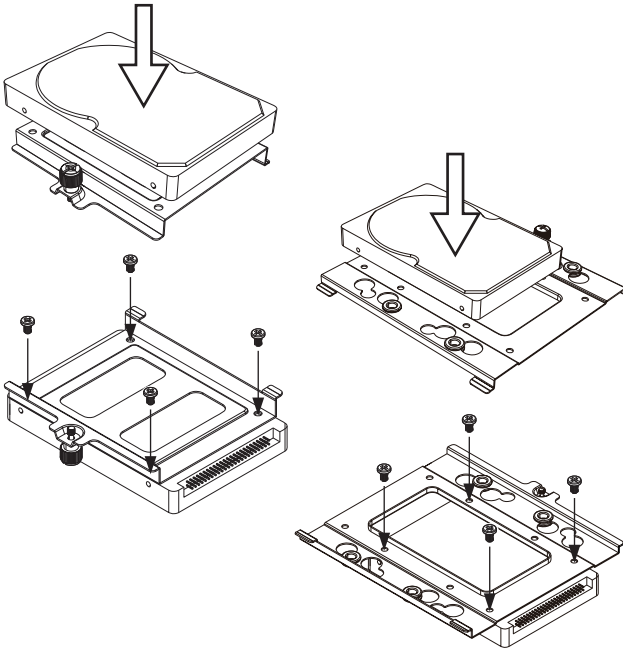

2.5" Drives Location

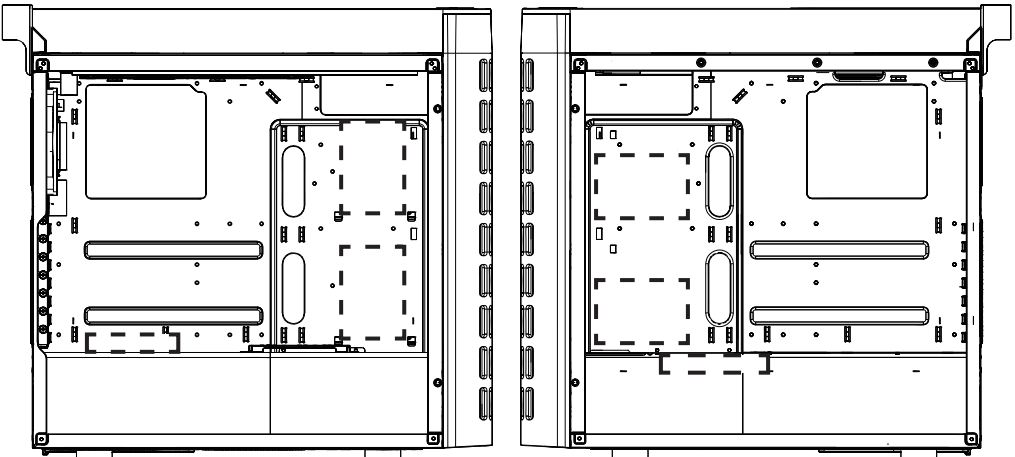

IO Control Panel

PANTODA ATX

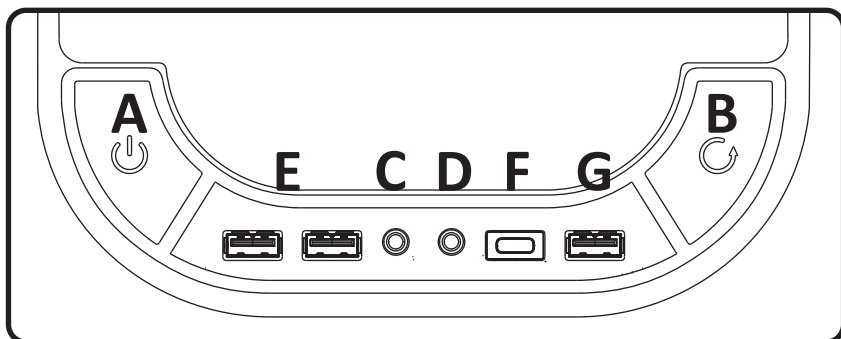

PANTODA ATX CORE

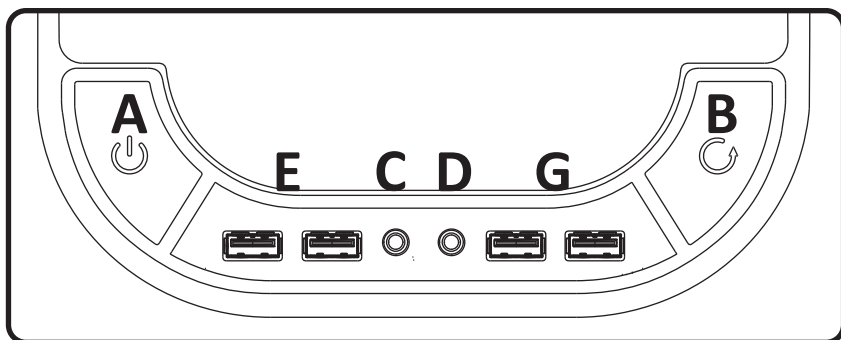

- A . Power button (Power LED)
- B . Reset button (HDD LED)
- C . Microphone jack
- D . Headphone jack
- E . SuperSpeed USB 3.0 ports
- F . USB 3.1 Type C
- G . USB 2.0 ports

Top Fan Installation (120mm)

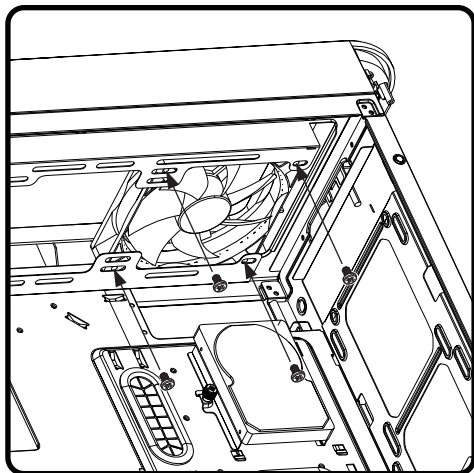
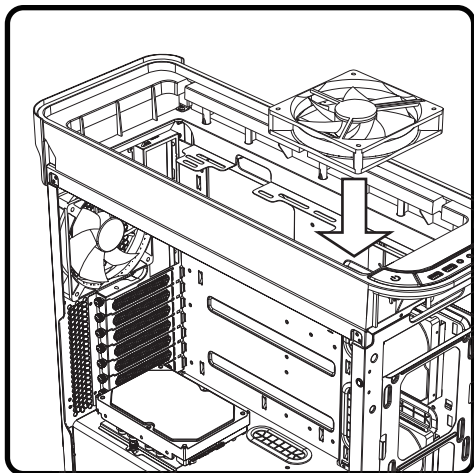

Front Fan Installation (120mm)

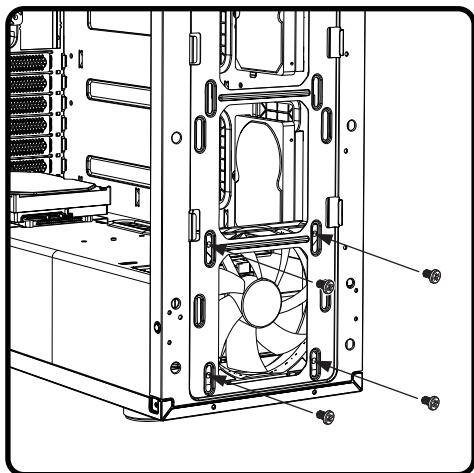
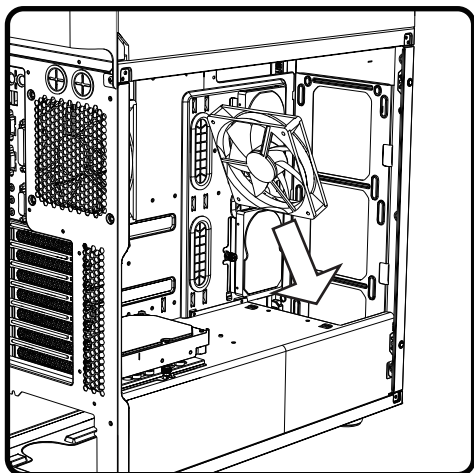

PSU Installation

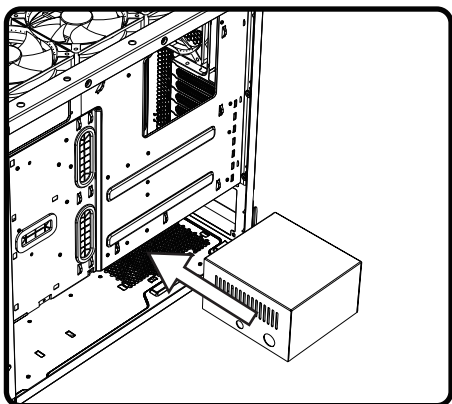

a. Install PSU from the side

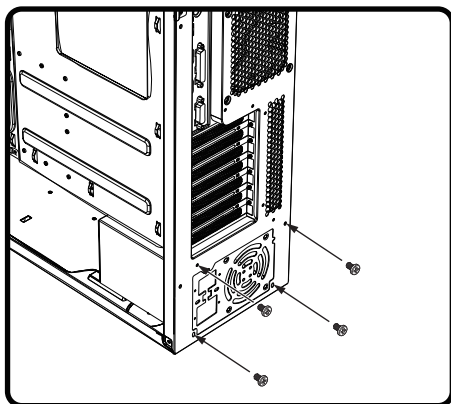

b. Secure with screws (4*6-32)

PCI-E Card Installation

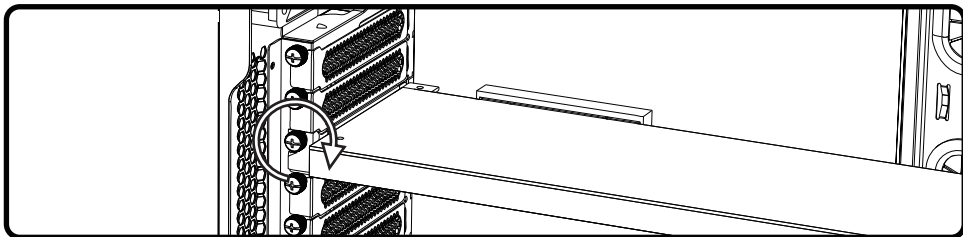
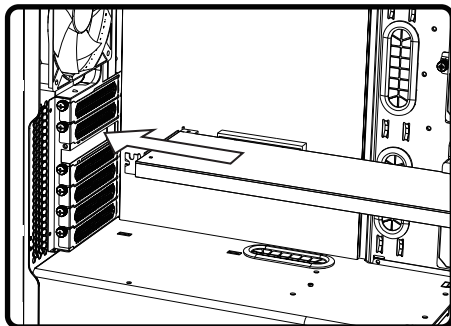
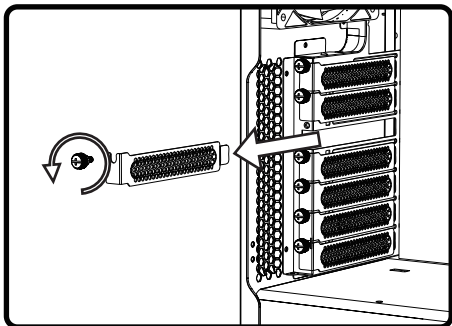

BitFenix ICON Programmable Display

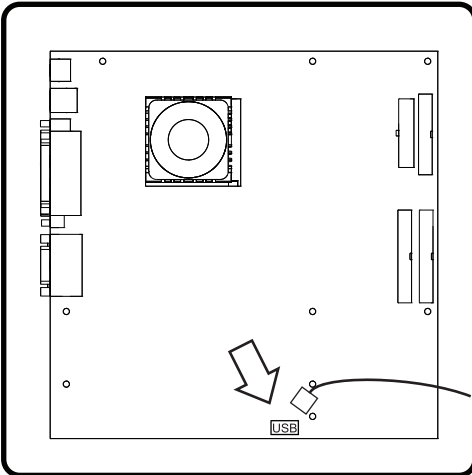

a. Attach USB connector to motherboard

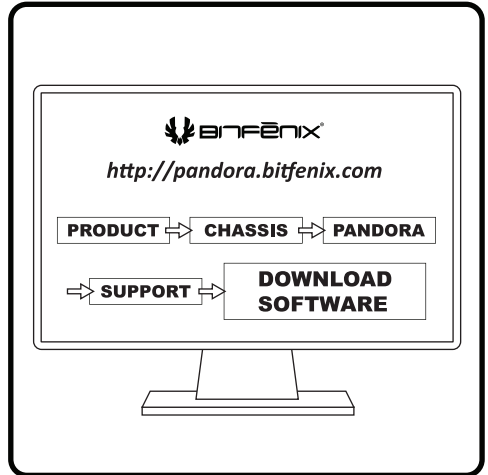

b. Download software and save to desktop

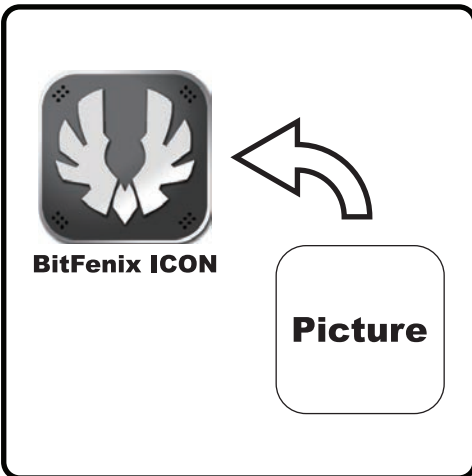

c. Drag and drop the picture file on to program icon (JPG.PNG.GIF)

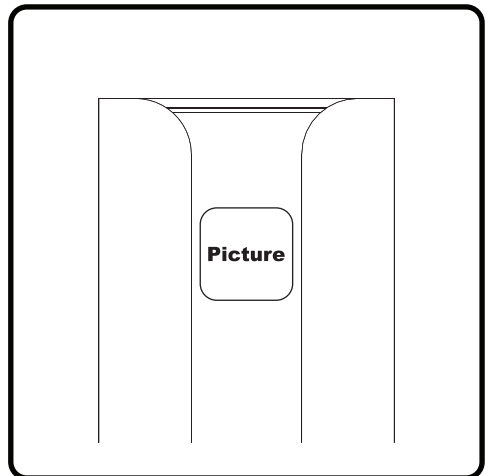

d. The new logo will display within a few seconds

BE INVINCIBLE

WWW.BITFENIX.COM



BitFenix Co., Ltd.

3F, No.79, Sec. 1, Xintai 5th Rd.,

BitFenix Xi Zhi District, New Taipei City, Taiwan, R.O.C.

© 2015 BITFENIX Co., Ltd. All Rights Reserved. All trademarks are registered to their respective owners

For the most updated information, please visit our official website : <http://www.bitfenix.com> Ver 1.0 | 2015/09