

Colossus Window

Quick Installation Guide

Box Contents

- **Colossus Case**
- **Accessory Pack**
 - Accessories:
 - ⊕ 5.25" to external 3.5" drive bay cover: x 1
 - ⊕ 5.25" to external 3.5" drive bay adapter: x 1 (pre-installed in chassis)
 - ⊕ Internal Speaker: x 1
 - ⊕ Cable Ties: x 10
 - ⊕ Cable Clips: x 5
 - ⊕ LED Control Board: x 1
 - Screws:
 - ⊕ 6-32*6mm Hex: x 4 (for PSU)
 - ⊕ 6-32*6mm Flat: x 19 (for MB, PCI slots)
 - ⊕ 6-32*10mm Round: x 7 (for securing HDD-tray to HDD-cage)
 - ⊕ M3*5mm Round: x 24 (for 2.5" HDD/SSD, 5.25" ODD, 3.5" FDD)
 - ⊕ Motherboard Standoffs: x 11

* Contents and specifications subject to change without notice.

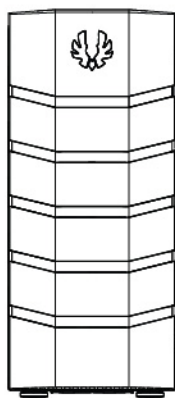

Front View

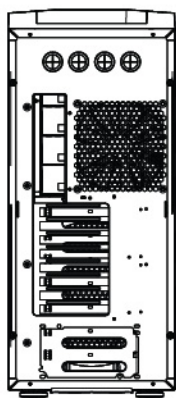

Back View

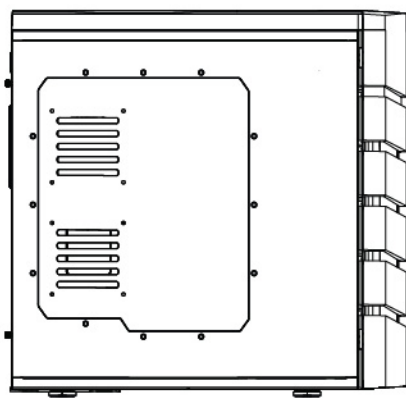

Side View

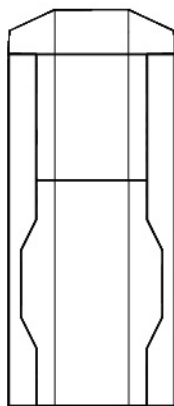

Top View

Basic Installation

1. Removing side panels

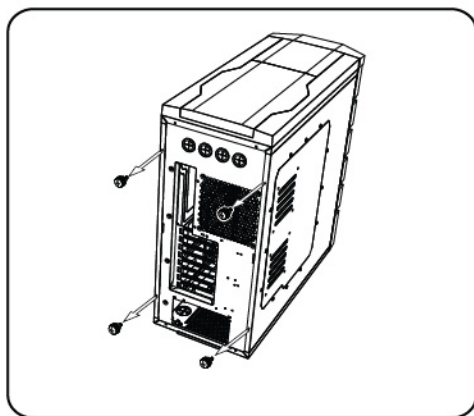

a. Remove thumbscrews

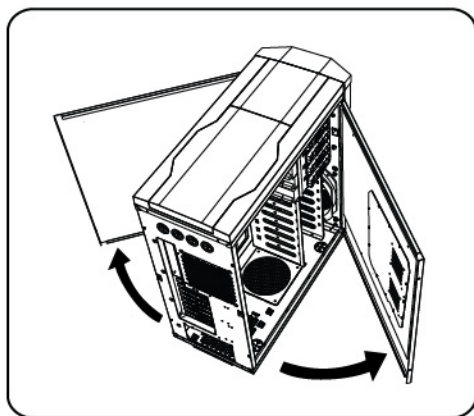

b. Slide off side panels

2. Installing 5.25" drives

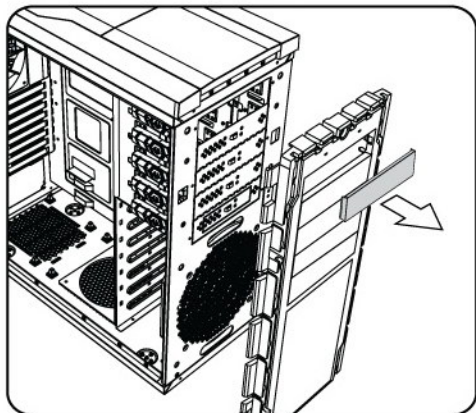

a. Remove drive cover

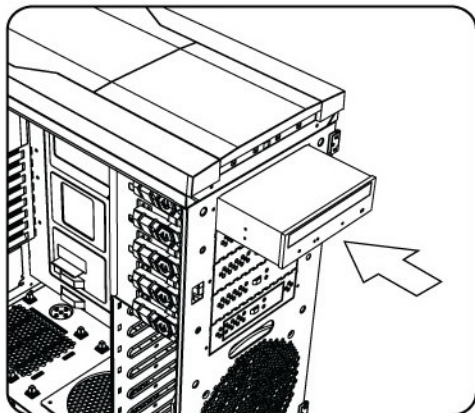

b. Slide drive into drive bay

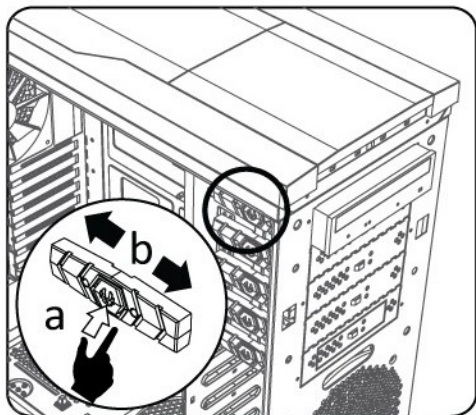

c. Press and slide drive locking mechanism to secure

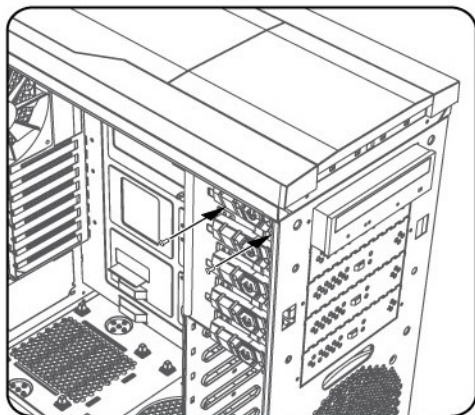

d. If needed, add extra M3*5mm Round screw for increased stability

3. Installing 3.5" drives

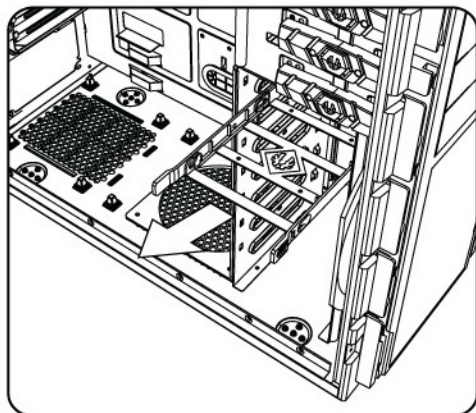

a. Remove hard disk tray

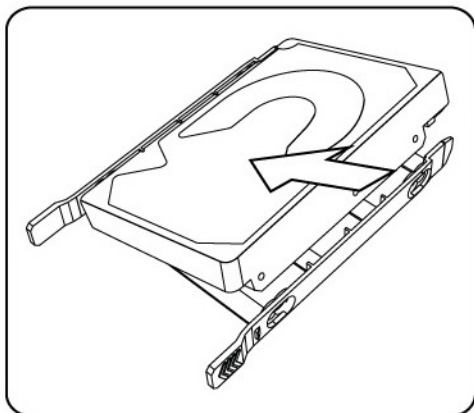

b. Install drive by bending rails of tray to the side

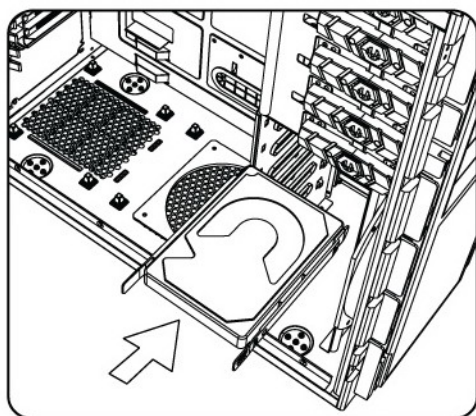

c. Slide tray into place

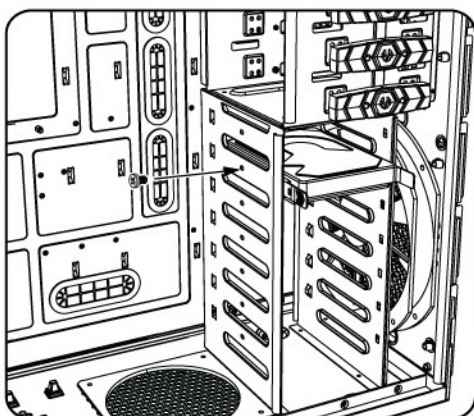

d. If needed, add extra 6-32*10mm Round screw for increased stability

4. Installing 2.5" drives

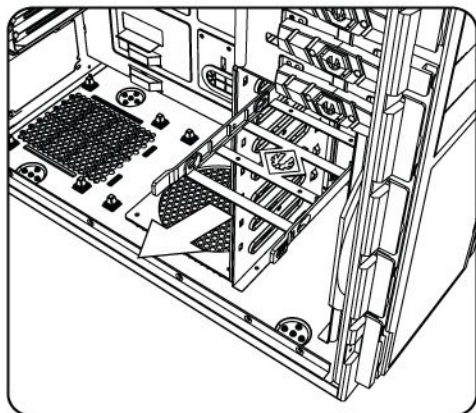

a. Remove hard disk tray

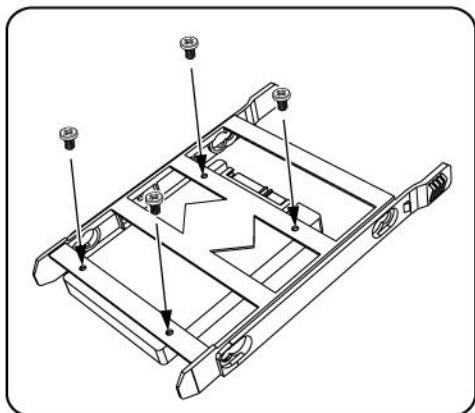

b. Install drive using M3*5mm Round screws

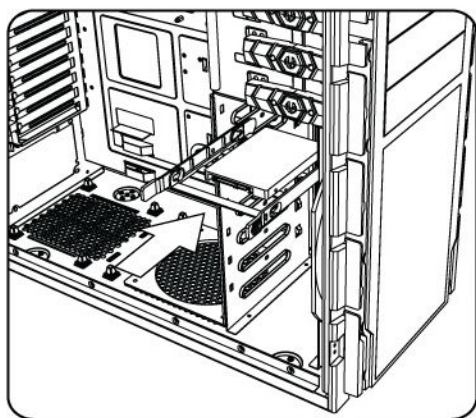

c. Slide tray into place

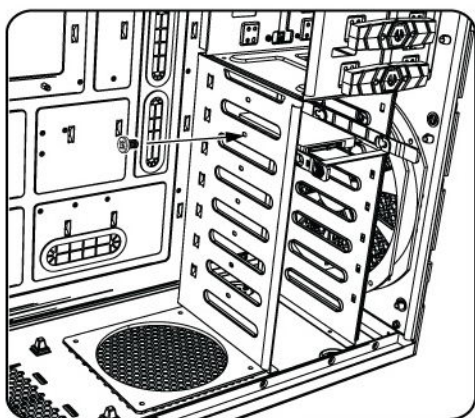

d. If needed, add extra 6-32*10mm Round screw for increased stability

5. LED Control Board Installation

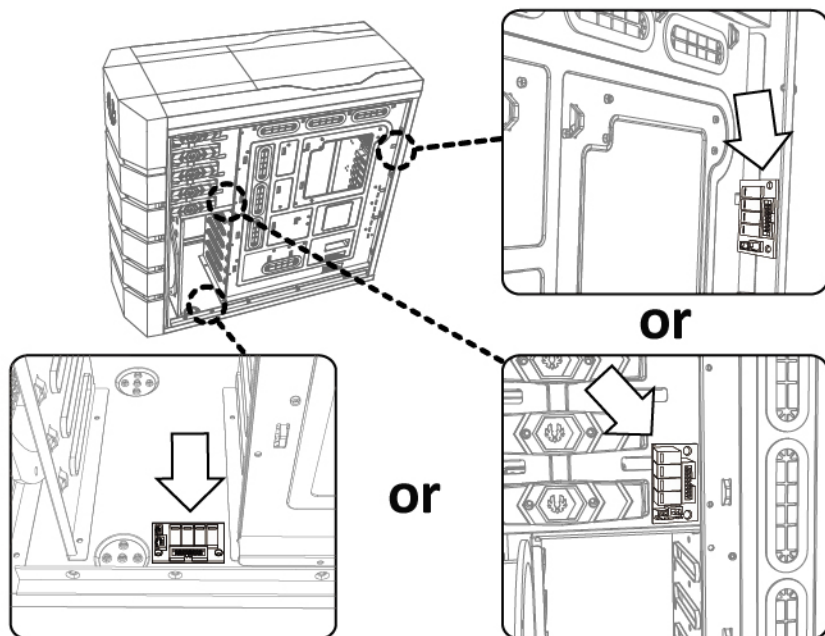

Connecting the Cables

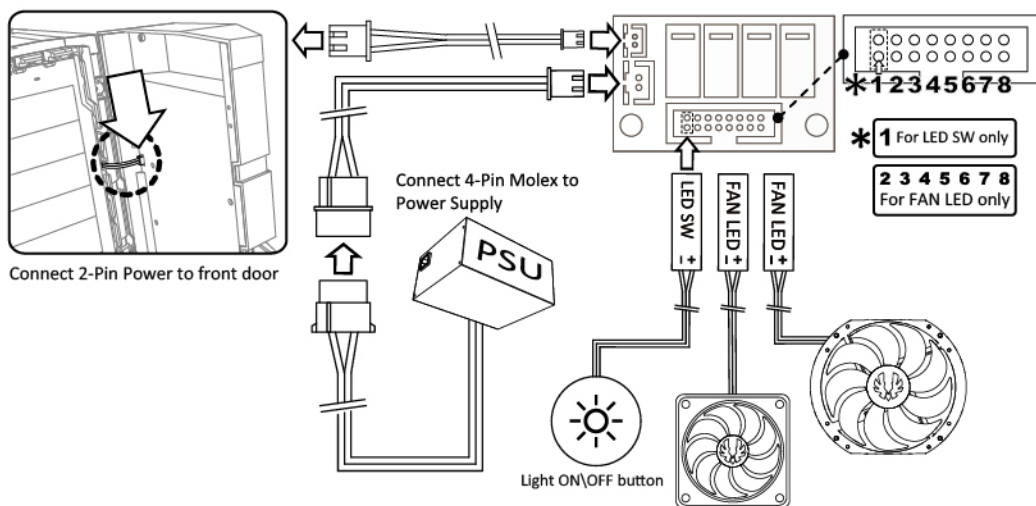

Connect 2-Pin Fan LEDs and LED Switch cables to the LED Control Board

6. Replacing side panels

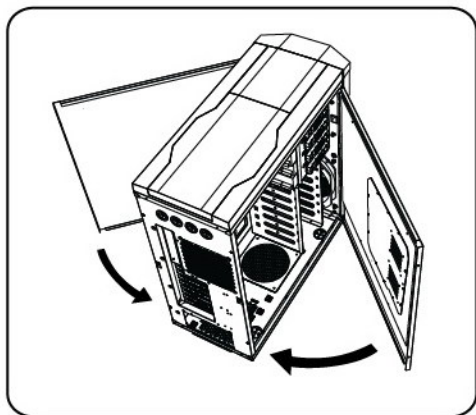

b. Install side panels

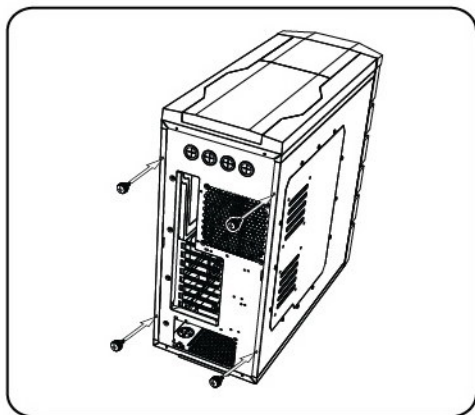

c. Replace thumbscrews

Features

Control Panel

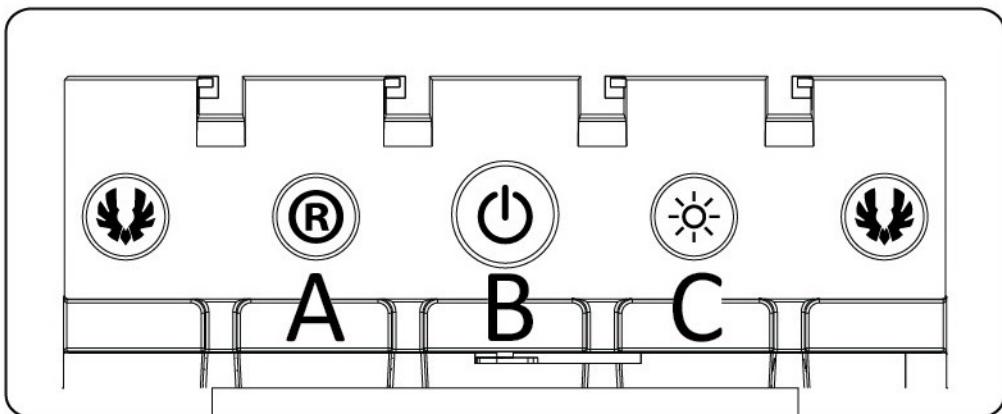

A. Reset switch
B. Power switch

C. LED switch

BitFenix S3™

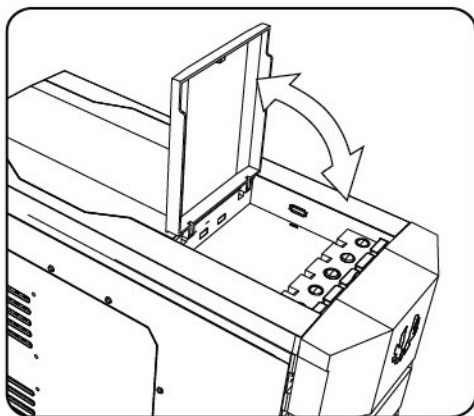

Opening and closing

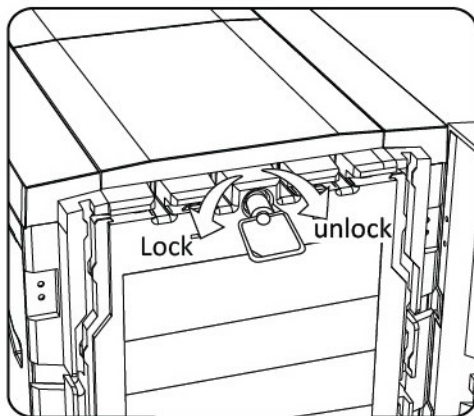

Locking and unlocking

External Cable Management

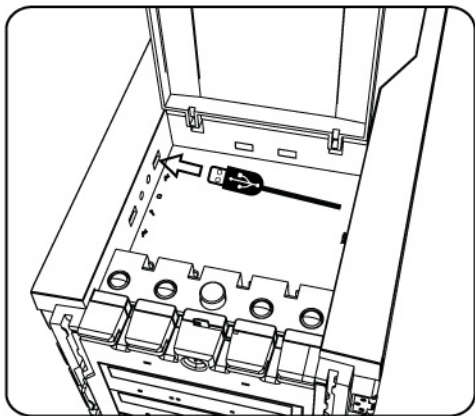

A. Plug in device

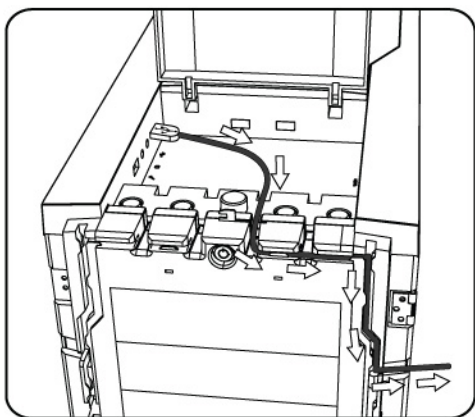

B. Route cable along cable grooves

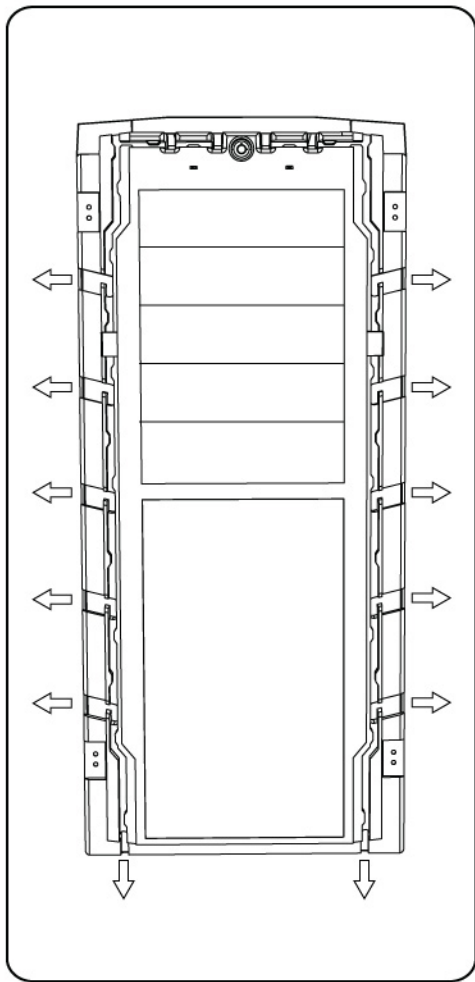

C. Select desired cable exit

Top Fan Installation

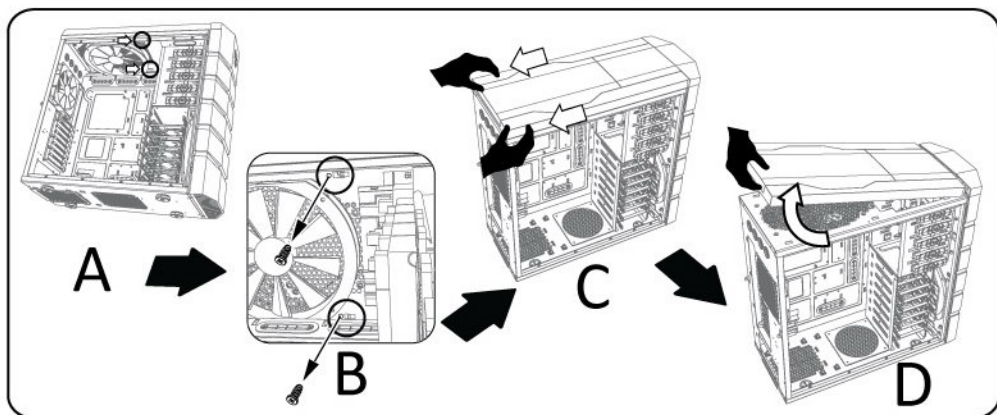

a. Remove top panel

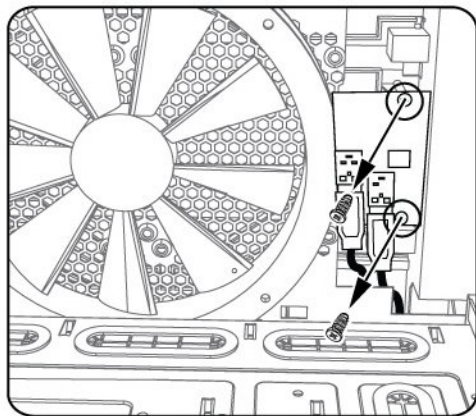

b. If needed, please remove USB3.0 PCB

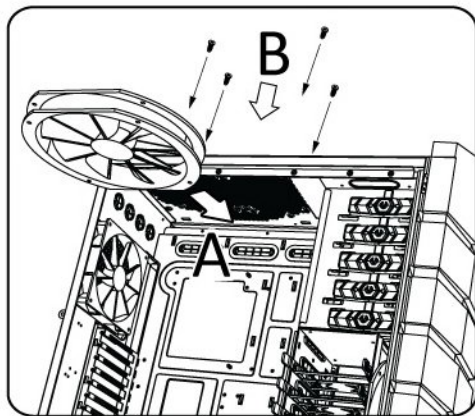

c. Replace existing fan

Front Fan Installation

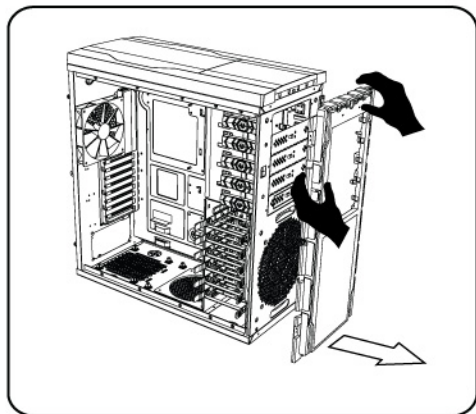

a. Remove front panel

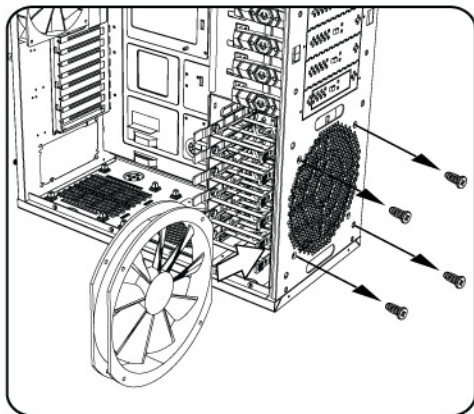

b. Replace existing fan

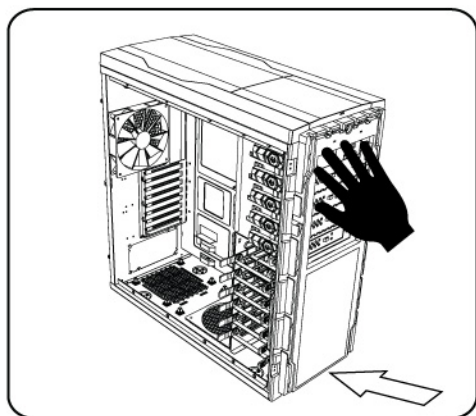

c. Replace front panel

Rear Fan Installation

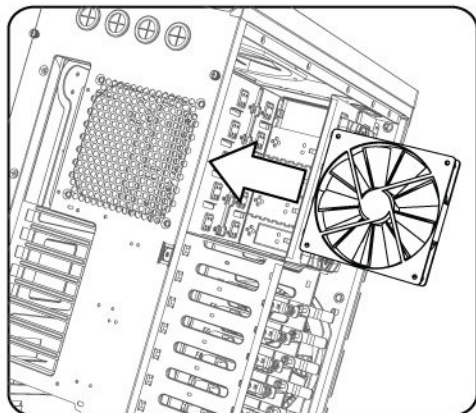

a. Install fan

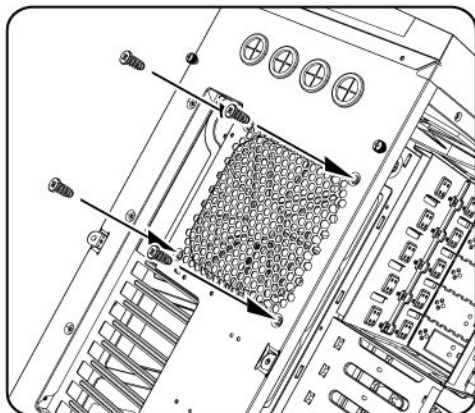

b. Secure with screws

Bottom Fan Installation

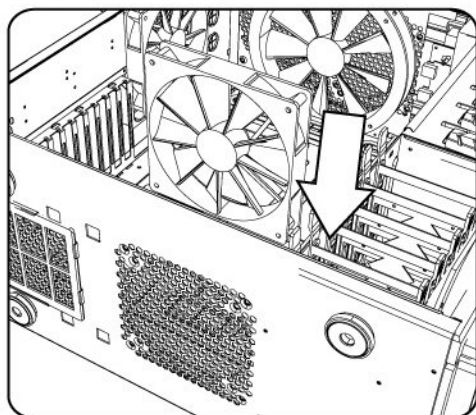

a. Install fan

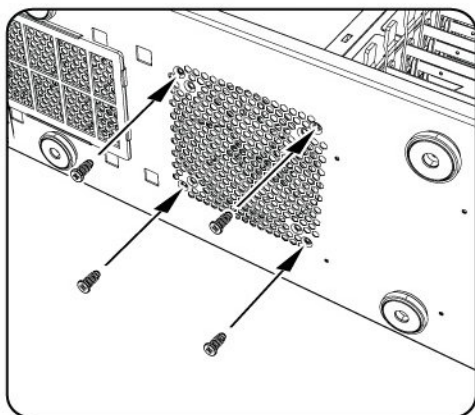

b. Secure with screws

Dust Filters

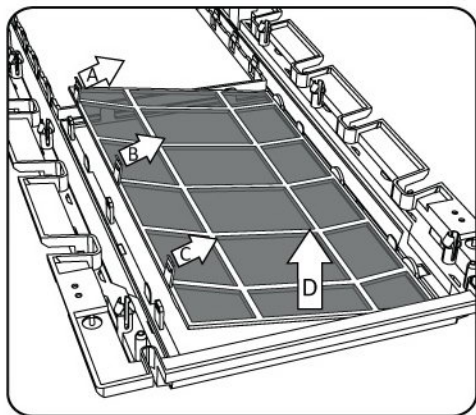

a. Removing front filter

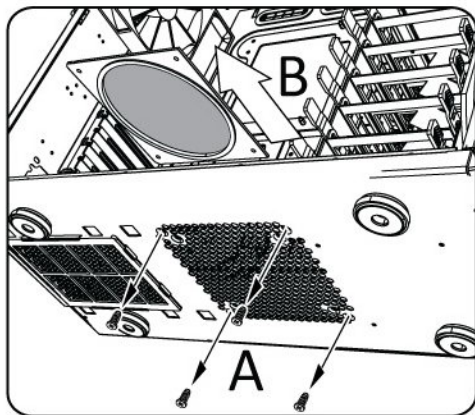

b. Removing bottom filter

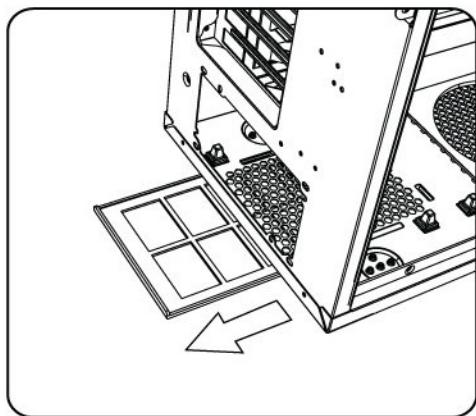

c. Removing PSU filter

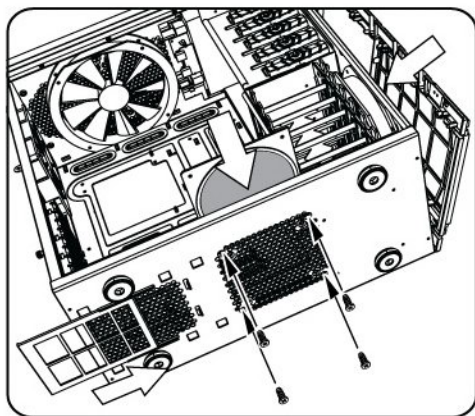

d. Replacing filters

Switchable Door Hinges

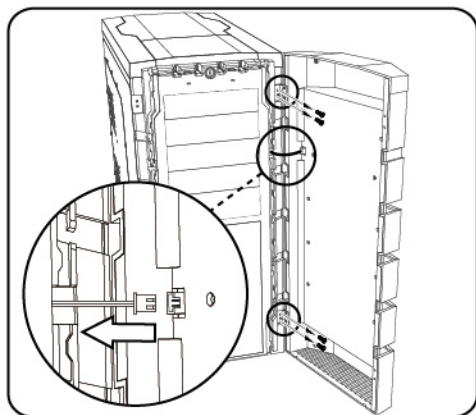

a. Remove screws and disconnect LED power connector

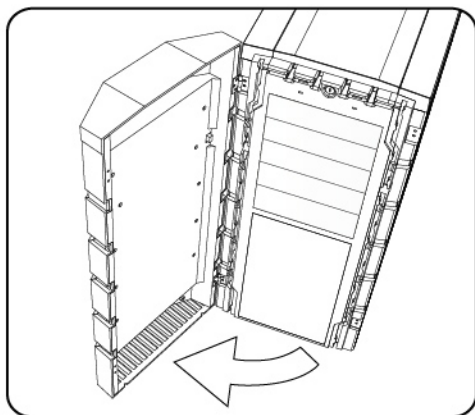

b. Switch hinges to other side

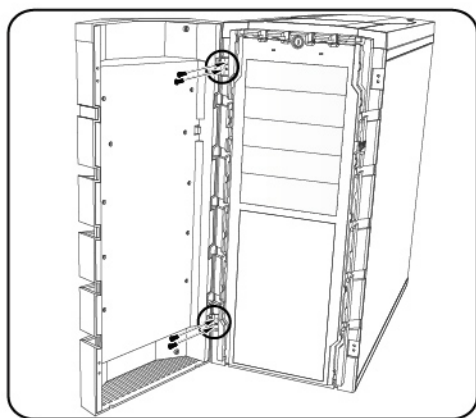

c. Replace screws

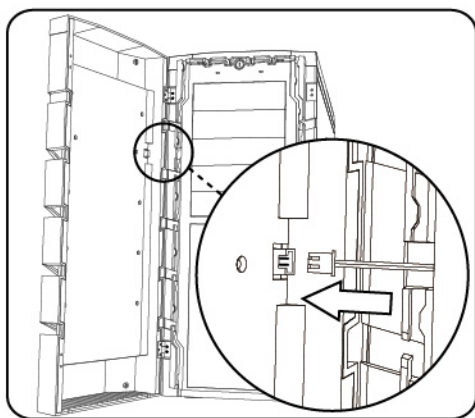

d. Connect door LED power connector

Side Panel Fan Installation

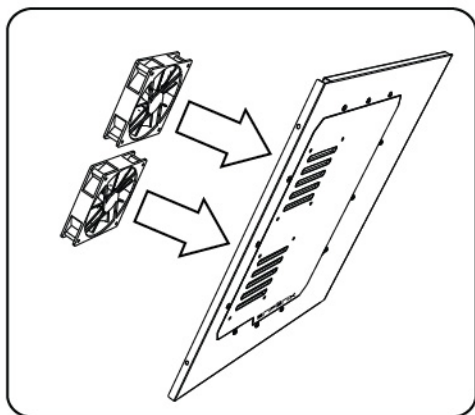

a. Install fans

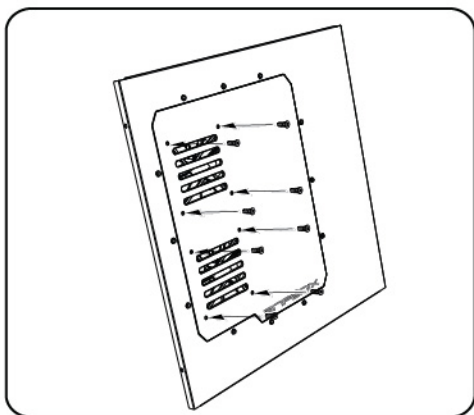

b. Secure with screws



bitfenix

Bitfenix Co., Ltd.

3F, No. 79, Sec. 1, Sintai 5th Rd.,
Sijhih city, Taipei, Taiwan, R.O.C.

For the most updated information, please visit our official website: <http://www.bitfenix.com>

© 2011 BITFENIX Co., Ltd. All Rights Reserved. All trademarks are registered to their respective owners.

Ver 1.1: 2011/05

